

"Smooth Star", "Fiber Classic" & "Classic Craft"

Glazed Fiberglass Double Door w/ or w/o Sidelites

IN SWING / OUT SWING
"Non-Impact"

EVALUATED FOR USE IN THE STATE OF TEXAS

The Therma-Tru FIBERGLASS door described herein complies with the 2006 International Residential Code (IRC), Sections R301 & R613 and the 2006 International Building Code (IBC), Sections 1405.12, 1609, 1714.5, 2403 and 2404 (including Texas revisions) subject to the following conditions:

1. Anchors shall be as listed and spaced as shown in the details. Anchor embedment to base material shall be beyond wall dressing or stucco.
2. When used in areas requiring wind-borne debris protection, the opaque doors do not require impact protection while the sidelites are required to be protected with an impact resistant covering that complies with Section R301.2.1.2 of the IRC and Section 1609.1.2 of the IBC.
3. Allowable design pressure requirements must be equal to or less than the design pressure rating shown in the design pressure chart, sheet 1 of this drawing.
4. Conditions not covered by this drawing are subject to further engineering analysis.

TABLE OF CONTENTS

SHEET #	DESCRIPTION
1	Typical elevations, design pressures & general notes
2	Door panel & glazing detail (Smooth Star/Fiber Classic)
3	Door panel & glazing detail (Smooth Star/Fiber Classic)
4	Door panel & glazing detail (Classic Craft)
5	Sidelite panel & glazing detail (Smooth Star/Fiber Classic)
6	Sidelite panel & glazing detail (Classic Craft)
7	Elevations
8	Horizontal cross sections
9	Vertical cross sections
10	Vertical cross sections
11	Frame anchoring
12	Astragal details
13	Bill of materials and components

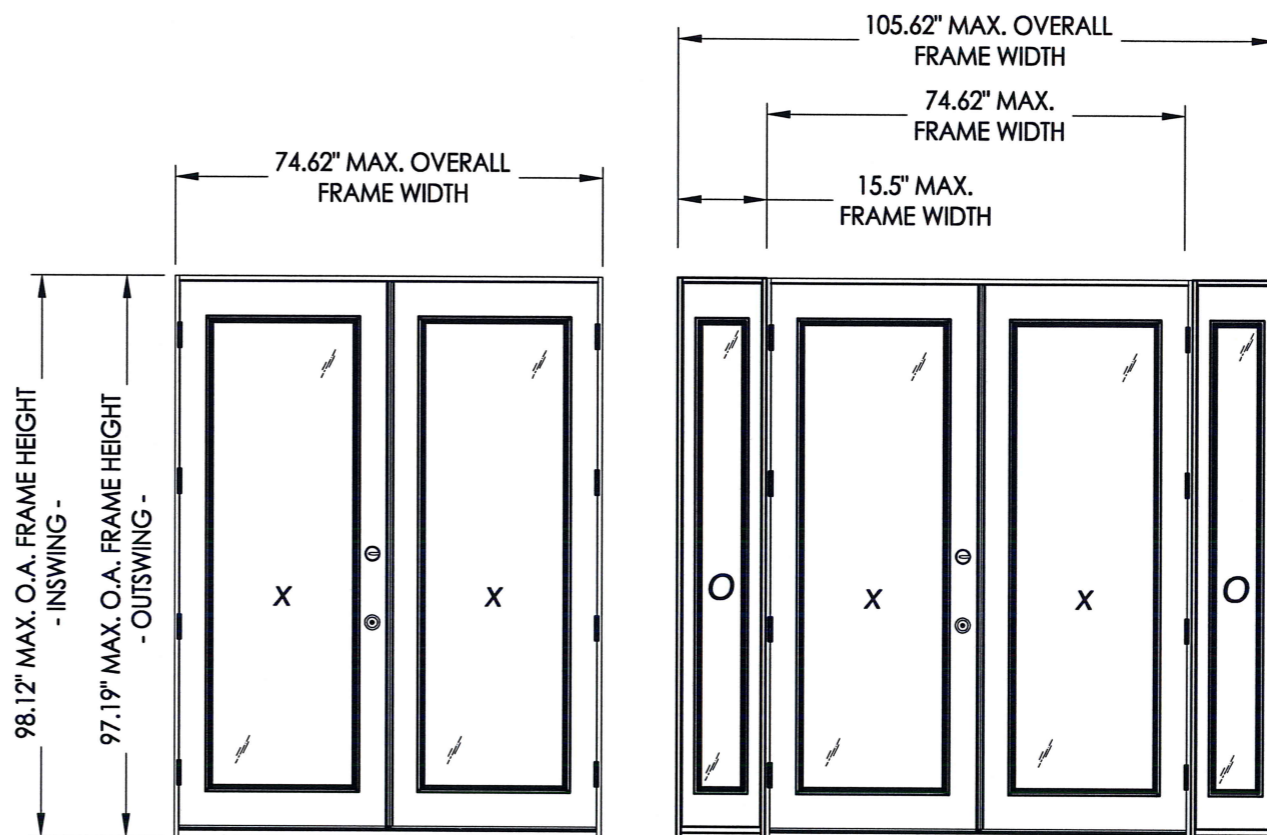

CONFIGURATION	MAX. FRAME DIMENSION	SWING	DESIGN PRESSURE (PSF)	
			POSITIVE	NEGATIVE
XX	74.62" x 98.12"	IN SWING	+30.0	-35.0
	74.62" x 97.19"	OUT SWING	+30.0	-30.0
OXXO	105.62" x 98.12"	IN SWING	+30.0	-35.0
	105.62" x 97.19"	OUT SWING	+30.0	-30.0



Documents Prepared By: Lyndon F. Schmidt, P.E.
TEXAS P.E. #104123

RW BUILDING CONSULTANTS, INC.
P.O. Box 230 Valrico FL 33595
Phone No.: 813.659.9197

TEXAS BOARD OF PROFESSIONAL ENGINEERS
CERTIFICATE OF REGISTRATION # F-11852

PRODUCT: THERMA-TRU FIBERGLASS DOOR
PART OR ASSEMBLY:
TYPICAL ELEVATION, DESIGN PRESSURES & GENERAL NOTES

NO.	DATE	BY	REVISIONS

DATE: 10/08/12
SCALE: N.T.S.
DWG. BY: JK
CHK. BY: LFS
DRAWING NO.: TX-4265
SHEET 1 OF 13

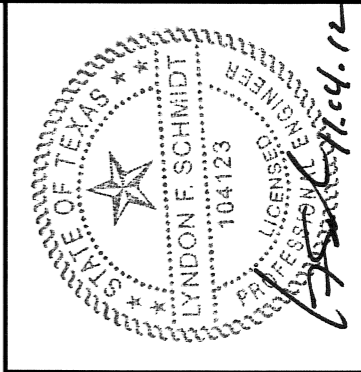

Documents Prepared By: Lyndon F. Schmidt, P.E.
 TEXAS P.E. #104123
 RW BUILDING CONSULTANTS, INC.
 P.O. Box 230 Valrico FL 33595
 Phone No.: 813.659.9197
 TEXAS BOARD OF PROFESSIONAL ENGINEERS
 CERTIFICATE OF REGISTRATION # F-11852

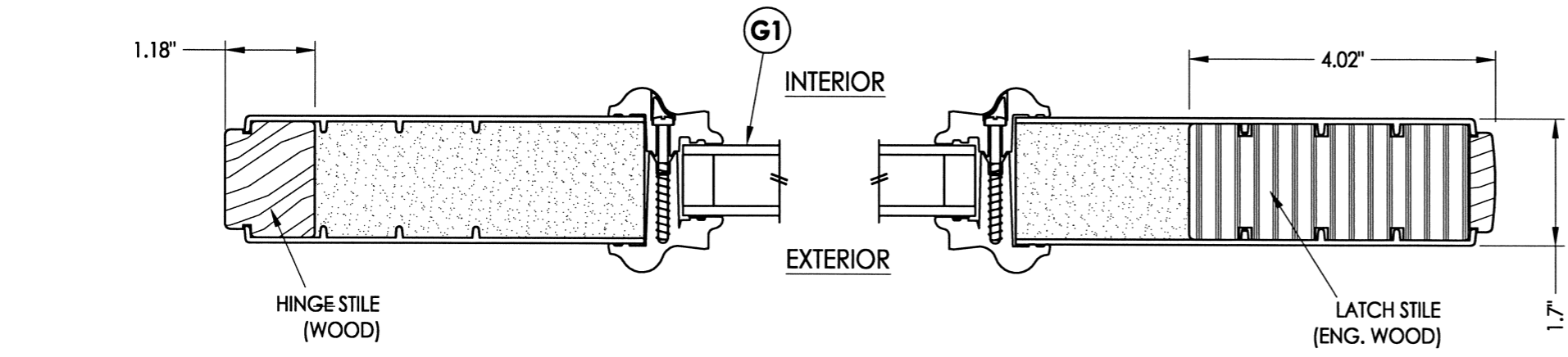

1
2 **HORIZONTAL CROSS SECTION**

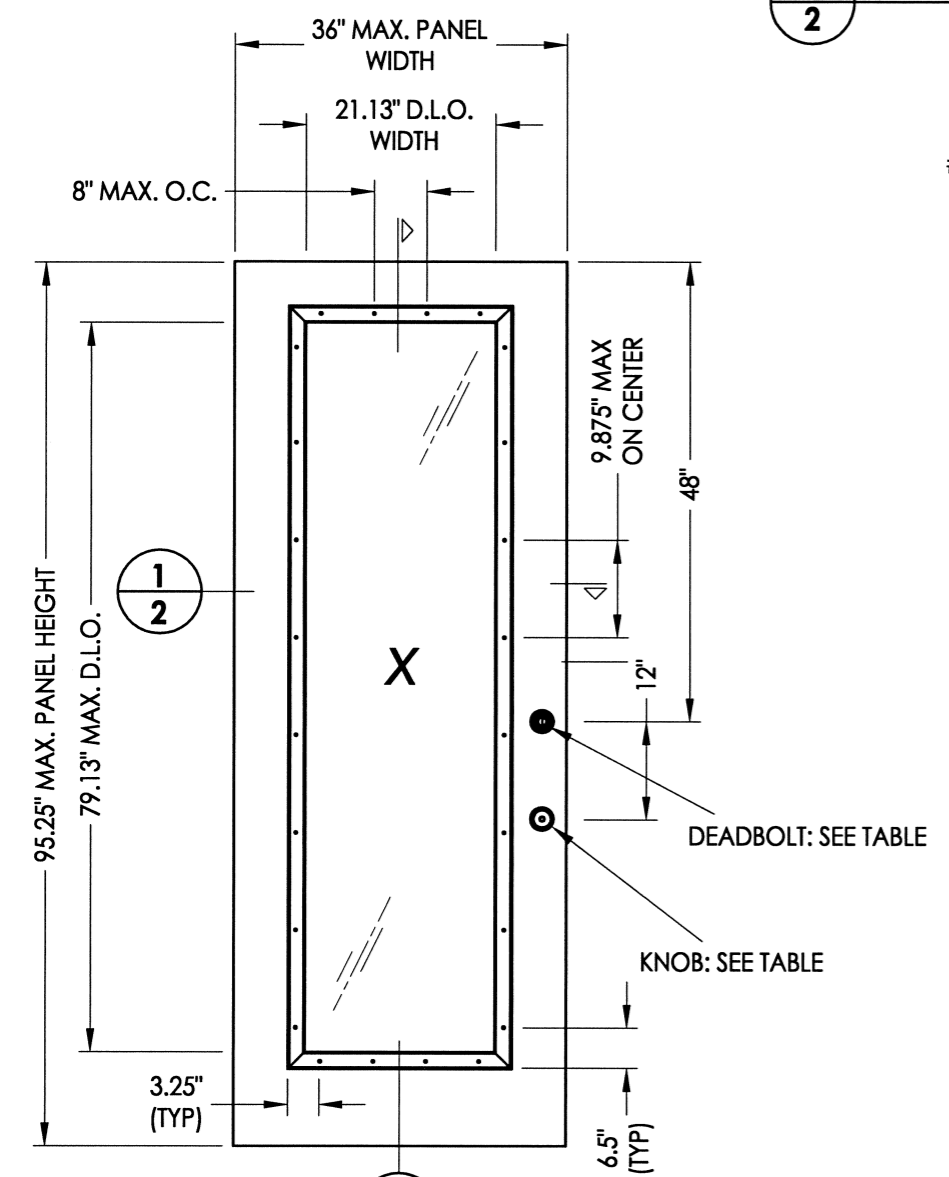

40 **DOOR PANEL**
Smooth Star/Fiber Classic

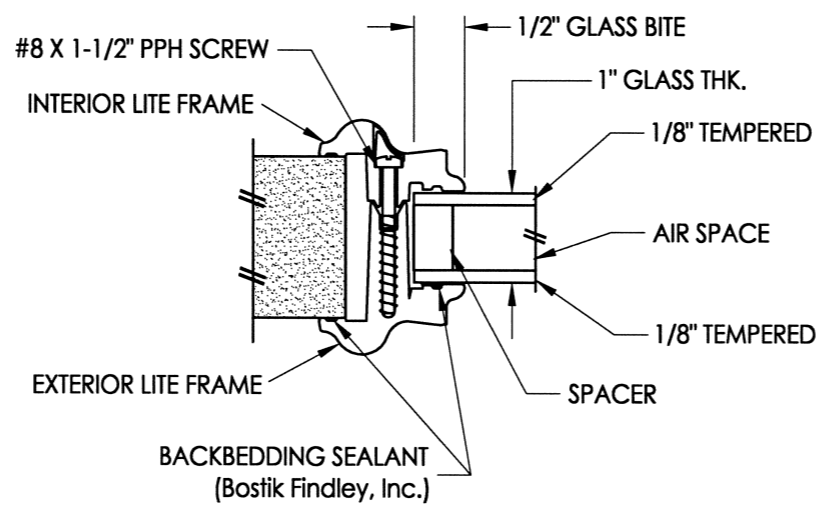

G1 **GLAZING DETAIL**
BTS Lip Lite Frame

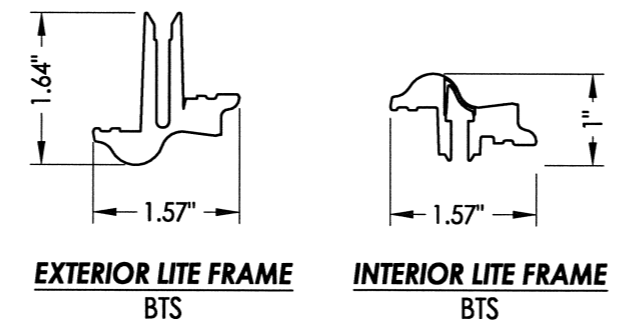

HARDWARE TABLE	
MANUFACTURER	MODEL
KWIKSET	KNOB: SIGNATURE SERIES
	DEADBOLT: SIGNATURE SERIES (980)
SCHLAGE	KNOB: "F" SERIES
	DEADBOLT: "B" SERIES

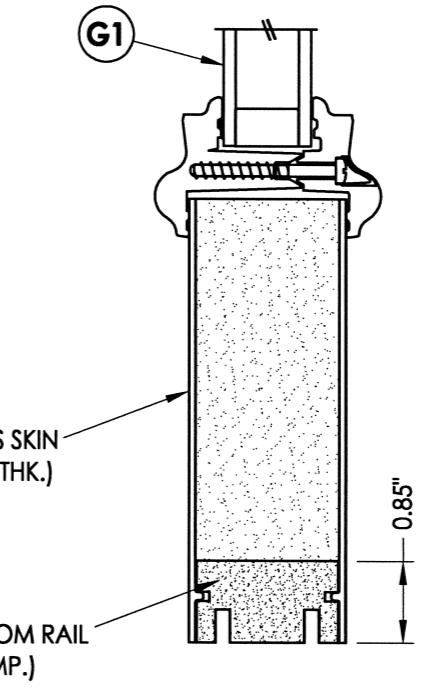
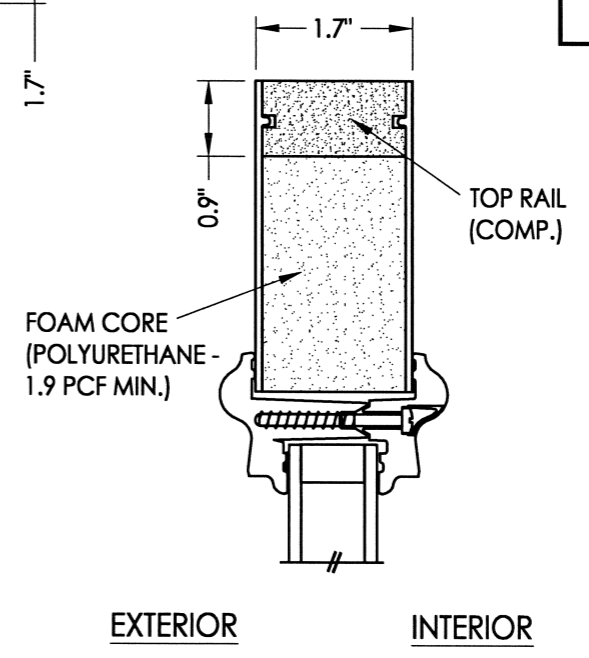

2
2 **VERTICAL CROSS SECTION**

PRODUCT: THERMA-TRU
FIBERGLASS DOOR
 PART OR ASSEMBLY:
 DOOR PANEL & GLAZING DETAIL
 (SMOOTH STAR/FIBER CLASSIC)

NO.	DATE	BY

DATE: 10/08/12
 SCALE: N.T.S.
 DWG. BY: JK
 CHK. BY: LFS
 DRAWING NO.: TX-4265
 SHEET 2 OF 13

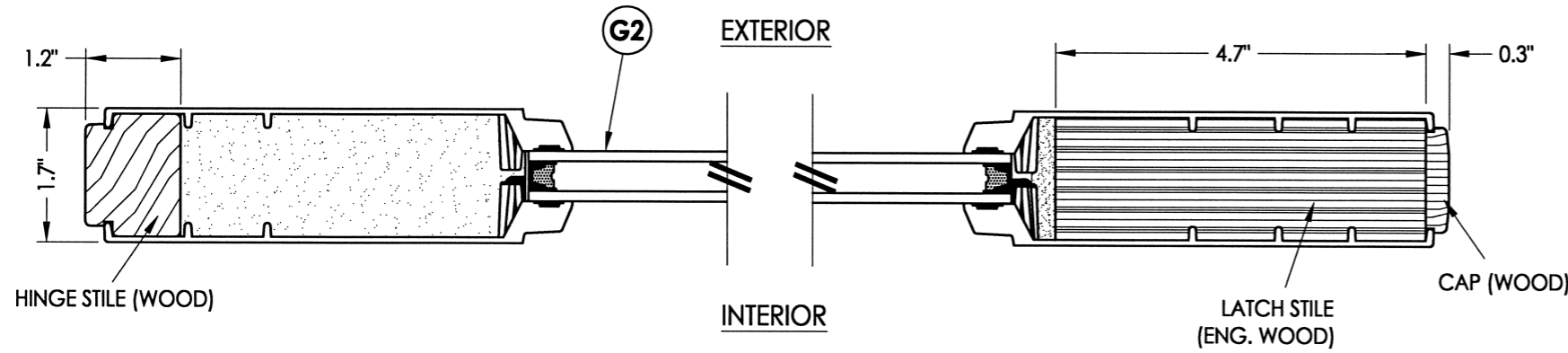

1
3 HORIZONTAL CROSS SECTION

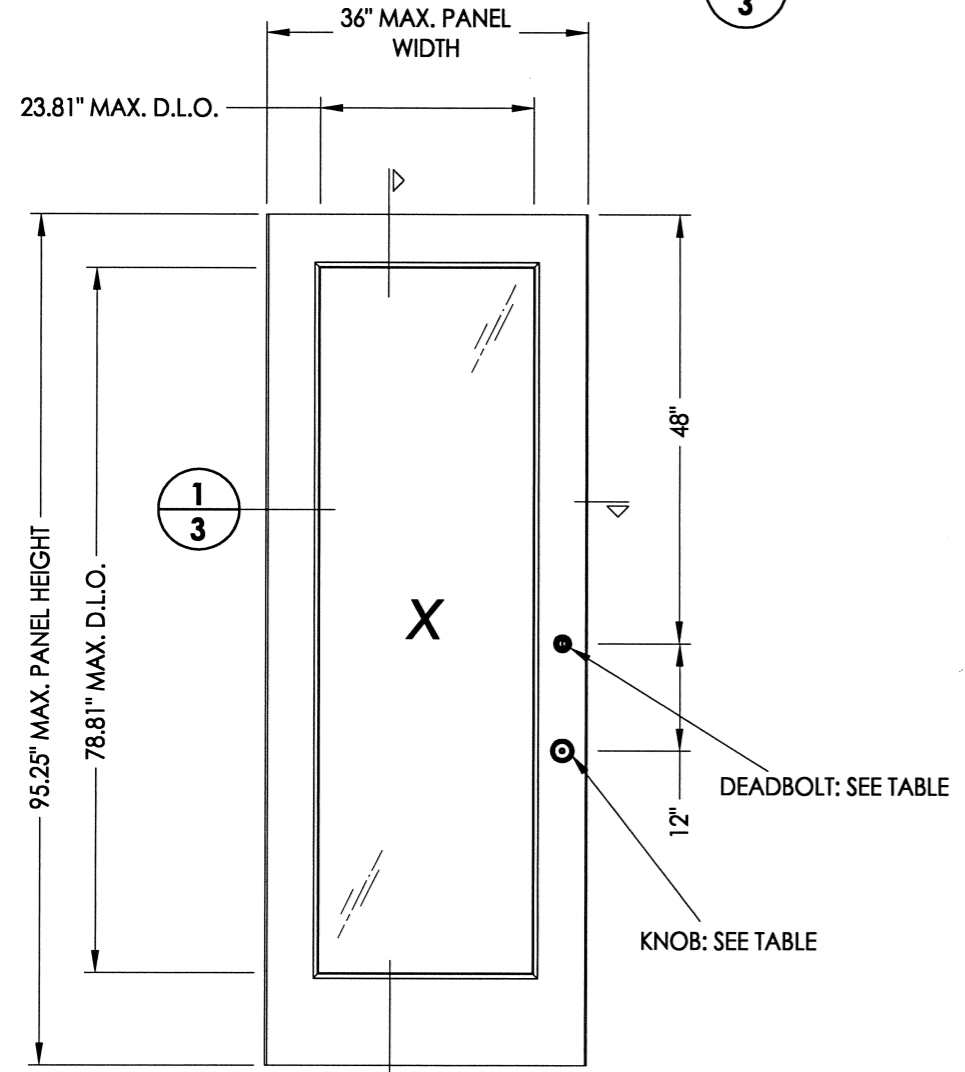

41 DOOR PANEL
Smooth Star/Fiber Classic

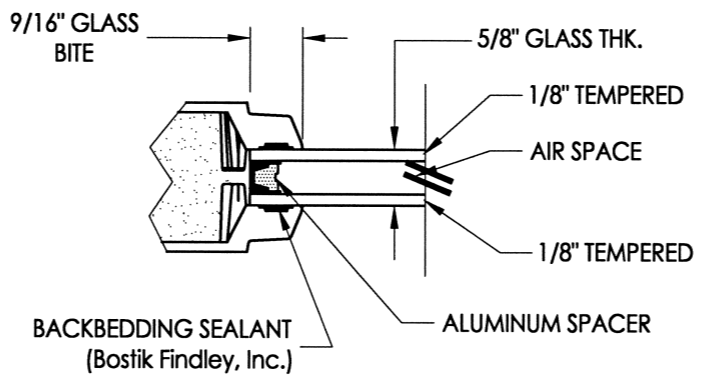

G2 GLAZING DETAIL
Flush Glazed

HARDWARE TABLE	
MANUFACTURER	MODEL
KWIKSET	KNOB: SIGNATURE SERIES DEADBOLT: SIGNATURE SERIES (980)
SCHLAGE	KNOB: "F" SERIES DEADBOLT: "B" SERIES

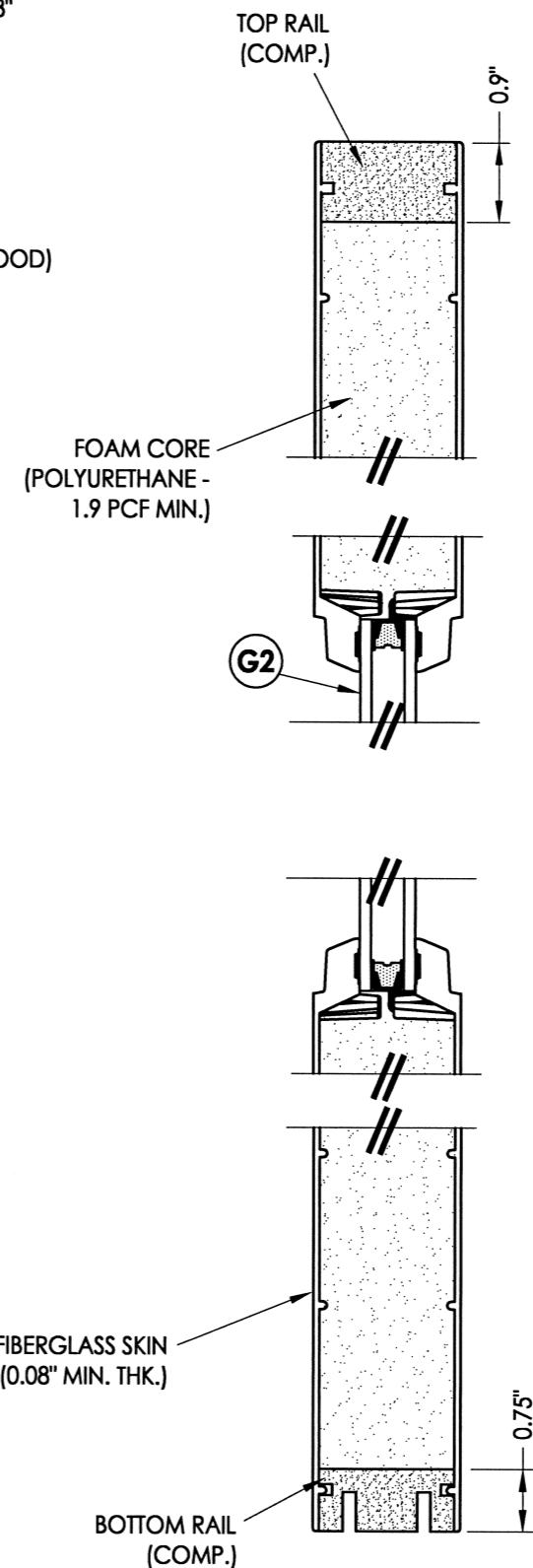

2
3 VERTICAL CROSS SECTION

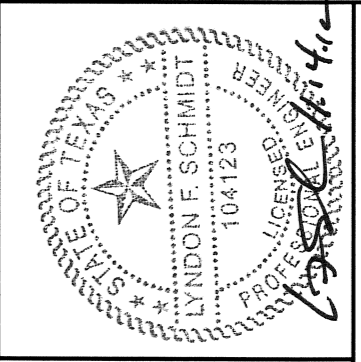

Documents Prepared By: Lyndon F. Schmidt, P.E.
TEXAS P.E. #104123

RW BUILDING CONSULTANTS, INC.
P.O. Box 230 Vairico FL 33595
Phone No.: 813.659.9197

TEXAS BOARD OF PROFESSIONAL ENGINEERS
CERTIFICATE OF REGISTRATION # F-11852

PRODUCT: THERMA-TRU
FIBERGLASS DOOR

PART OR ASSEMBLY:
DOOR PANEL & GLAZING DETAIL
(SMOOTH STAR/FIBER CLASSIC)

NO.	DATE	BY	REVISIONS

DATE: 10/08/12
SCALE: N.T.S.
DWG. BY: JK
CHK. BY: LFS
DRAWING NO.: TX-4265
SHEET 3 OF 13

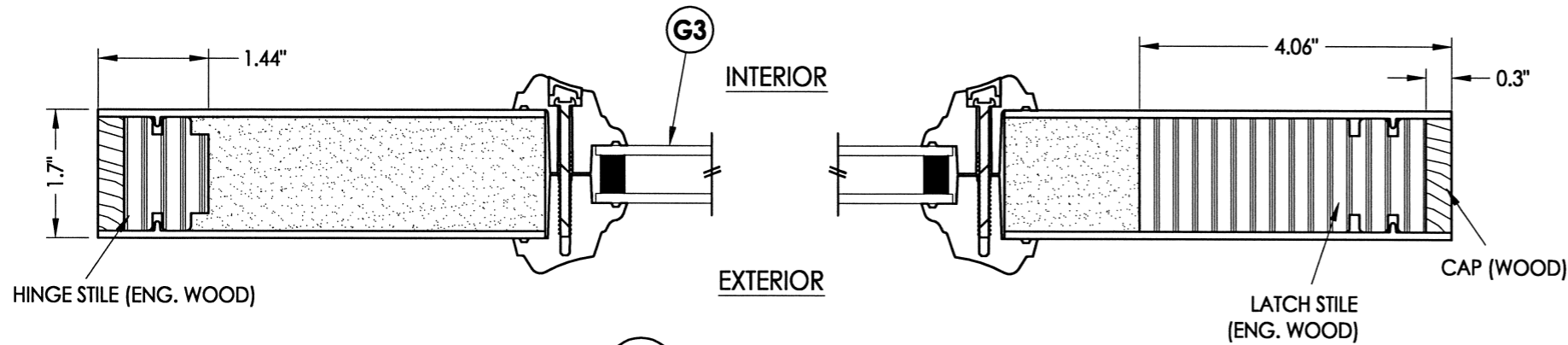

1/4 HORIZONTAL CROSS SECTION

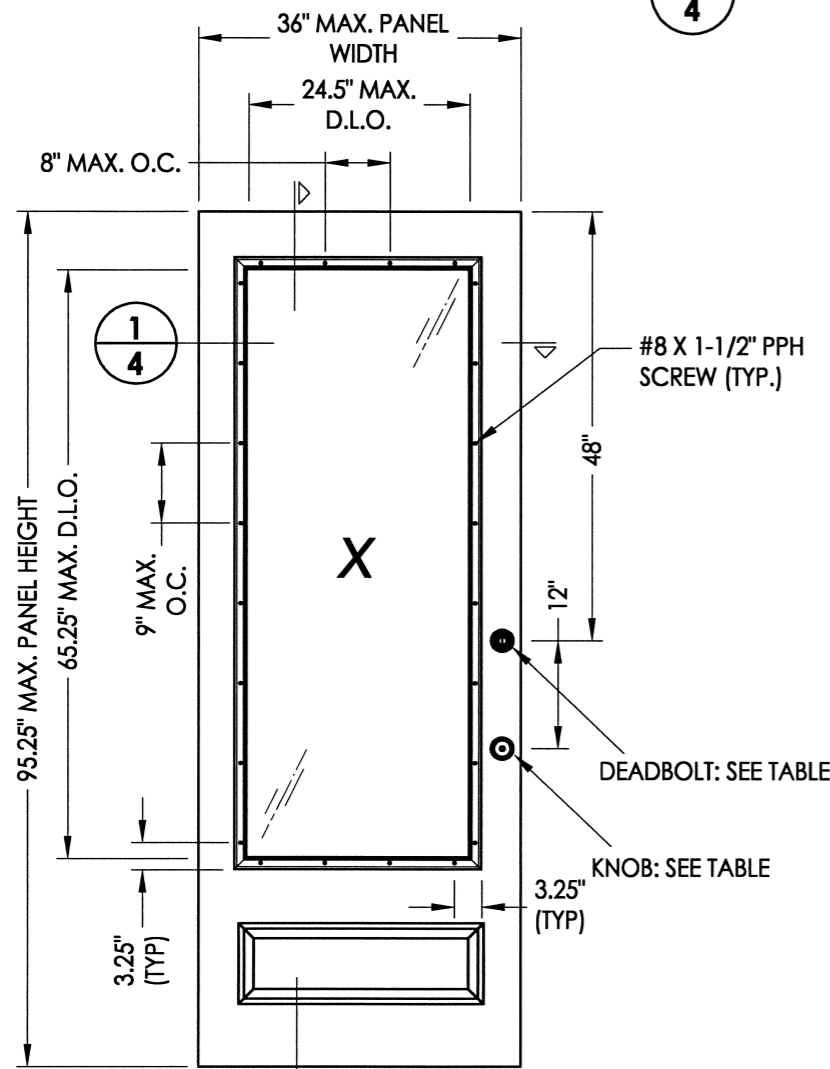

2/4 DOOR PANEL Classic Craft

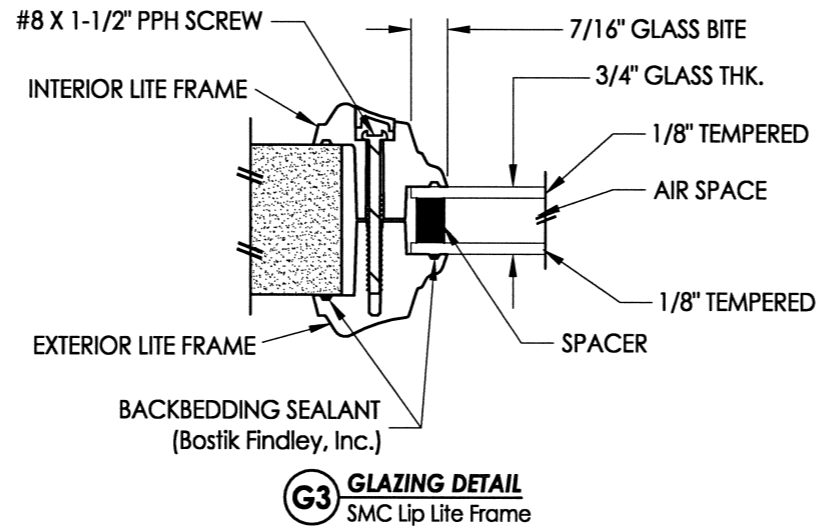

G3 GLAZING DETAIL SMC Lip Lite Frame

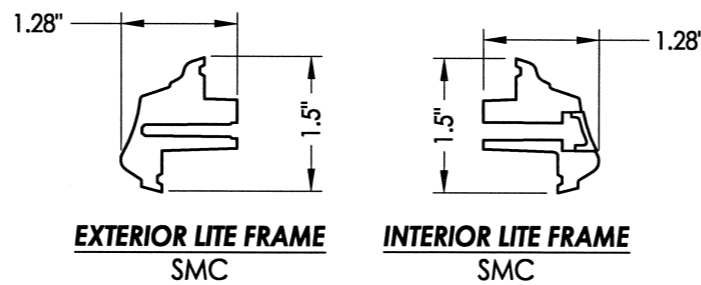

HARDWARE TABLE	
MANUFACTURER	MODEL
KWIKSET	KNOB: SIGNATURE SERIES DEADBOLT: SIGNATURE SERIES (980)
SCHLAGE	KNOB: "F" SERIES DEADBOLT: "B" SERIES

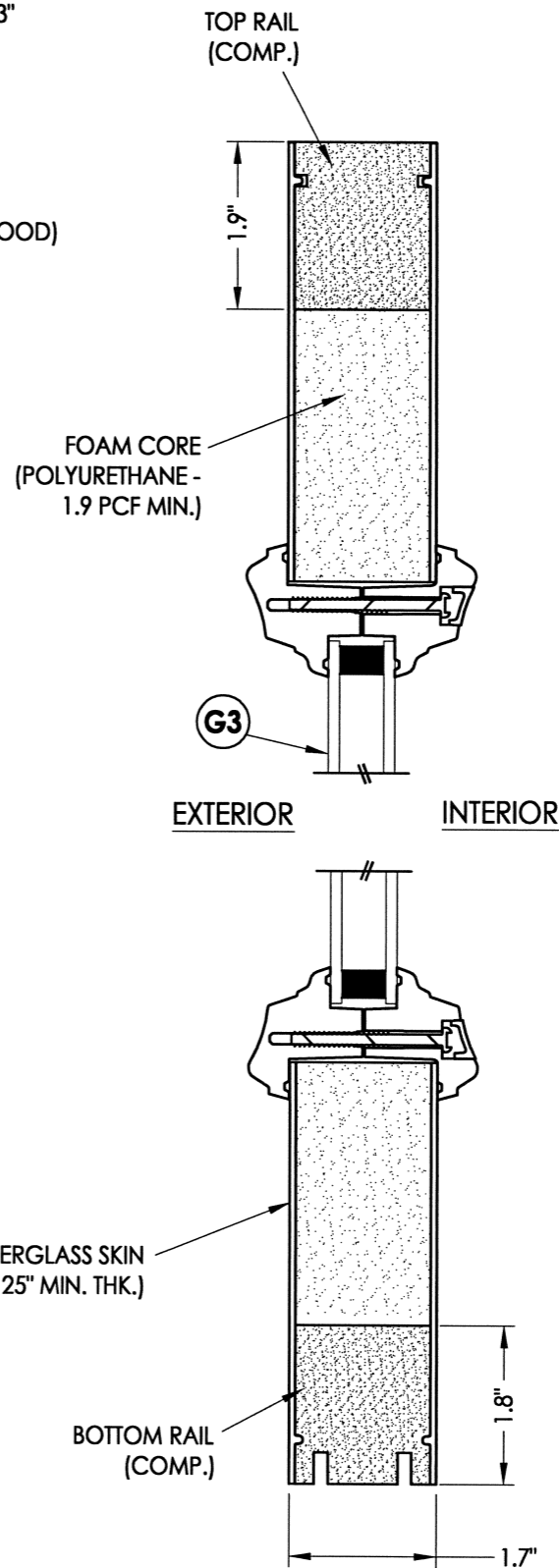

2/4 VERTICAL CROSS SECTION

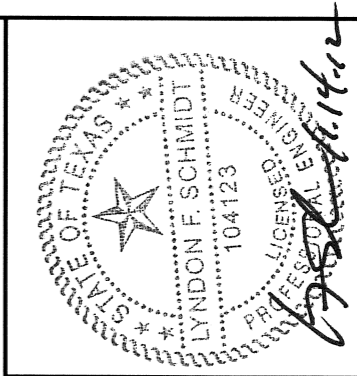

Documents Prepared By: Lyndon F. Schmidt, P.E.
TEXAS P.E. #104123

RW BUILDING CONSULTANTS, INC.
P.O. Box 230 Valrico FL 33595
Phone No.: 813.659.9197
TEXAS BOARD OF PROFESSIONAL ENGINEERS
CERTIFICATE OF REGISTRATION # F-11852

PRODUCT:	THERMA-TRU FIBERGLASS DOOR
PART OR ASSEMBLY:	DOOR PANEL & GLAZING DETAIL (CLASSIC CRAFT)

NO.	DATE	BY	REVISIONS

DATE:	10/08/12
SCALE:	N.T.S.
DWG. BY:	JK
CHK. BY:	LFS
DRAWING NO.:	TX-4265
SHEET	4 OF 13

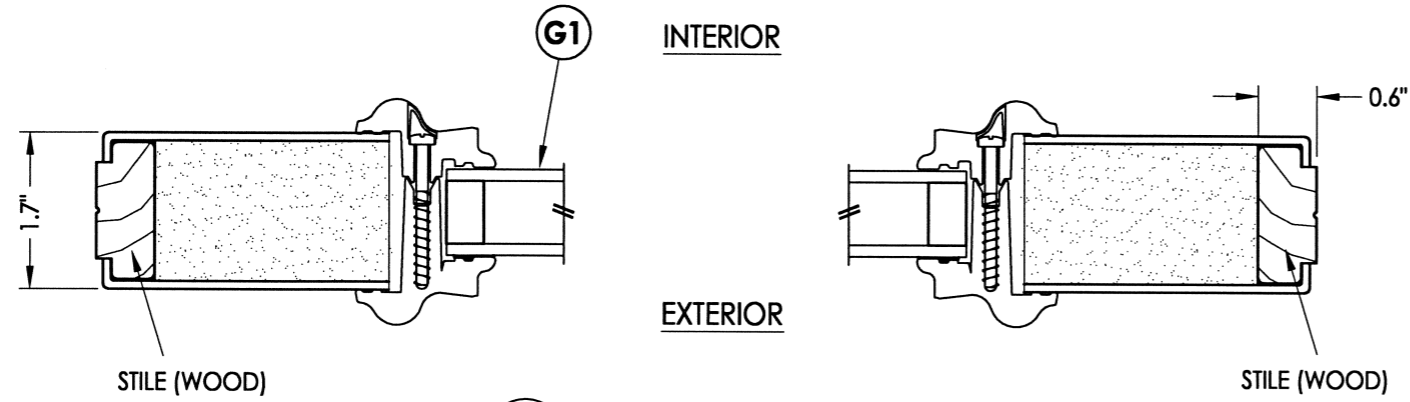

1
5 HORIZONTAL CROSS SECTION

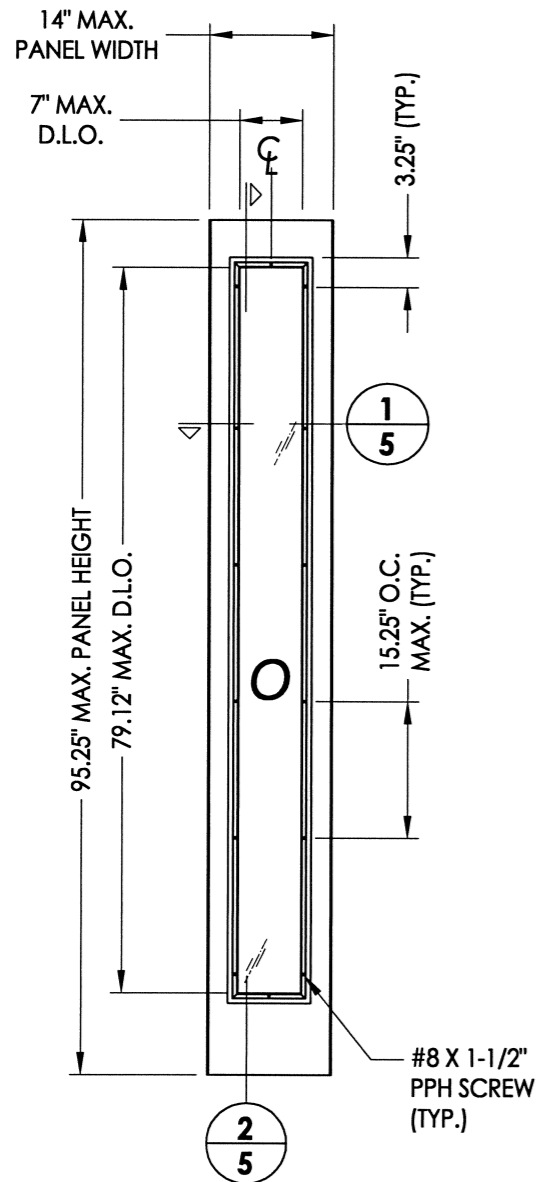

50 SIDELITE PANEL
Smooth Star/Fiber Classic

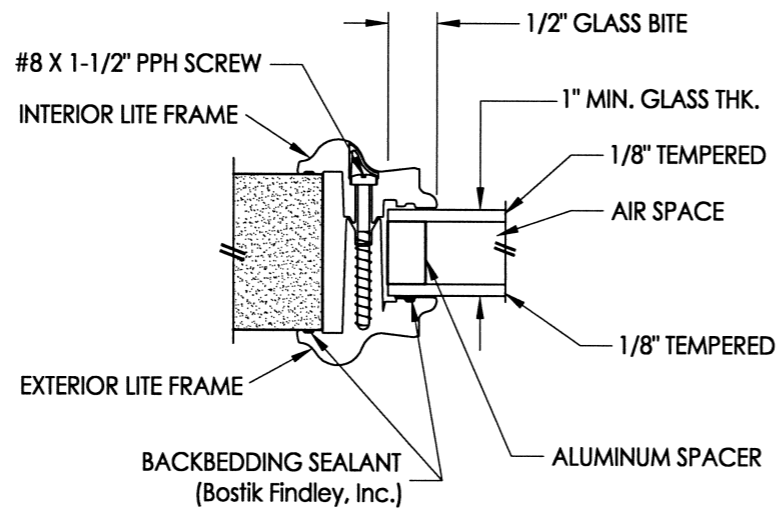

G1 GLAZING DETAIL
Lip Lite Frame

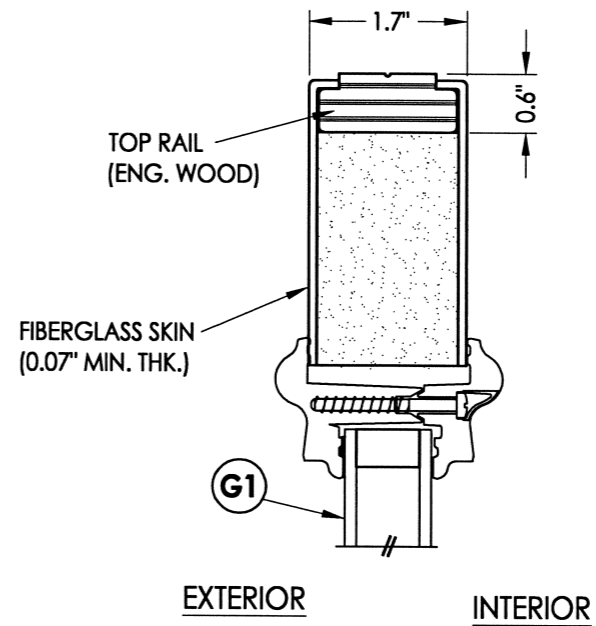
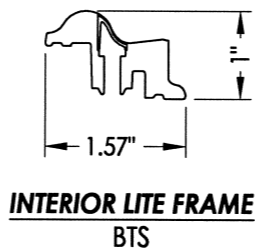
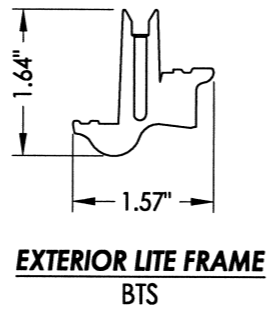

2
5 VERTICAL CROSS SECTION

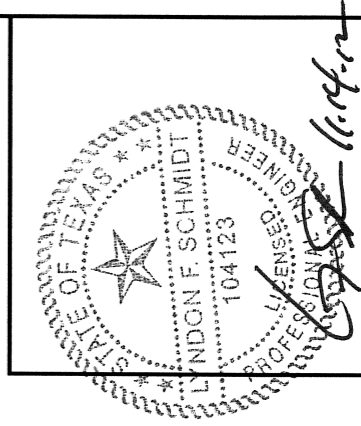

Documents Prepared By: Lyndon F. Schmidt, P.E.
TEXAS P.E. #104123

RW BUILDING CONSULTANTS, INC.
P.O. Box 230 Valrico FL 33595
Phone No.: 813.659.9197

TEXAS BOARD OF PROFESSIONAL ENGINEERS
CERTIFICATE OF REGISTRATION # F-11852

PRODUCT: THERMA-TRU FIBERGLASS DOOR	
PART OR ASSEMBLY: SIDELITE PANEL & GLAZING DETAIL (SMOOTH STAR/FIBER CLASSIC)	
NO.	REVISIONS
DATE	BY
10/08/12	JK
DATE: 10/08/12	
SCALE: N.T.S.	
DWG. BY: JK	
CHK. BY: LFS	
DRAWING NO.: TX-4265	
SHEET 5 OF 13	

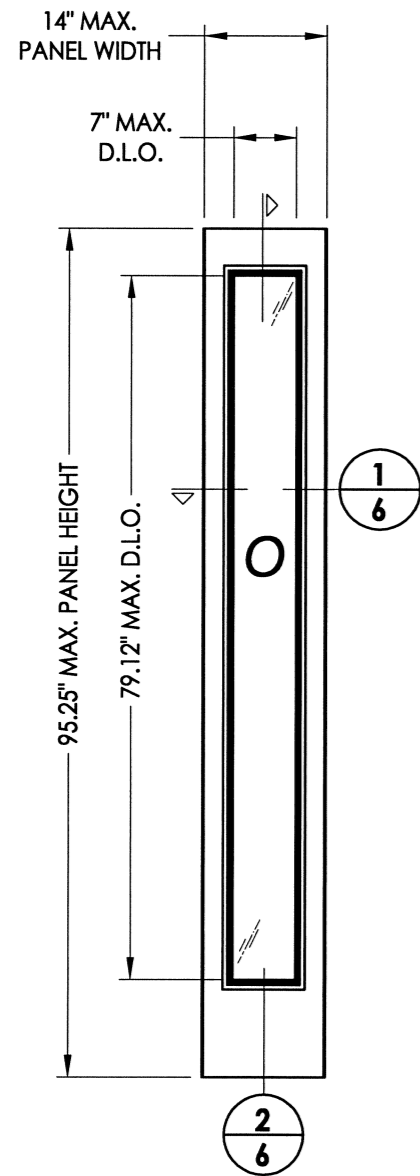

51 SIDELITE PANEL
Classic Craft

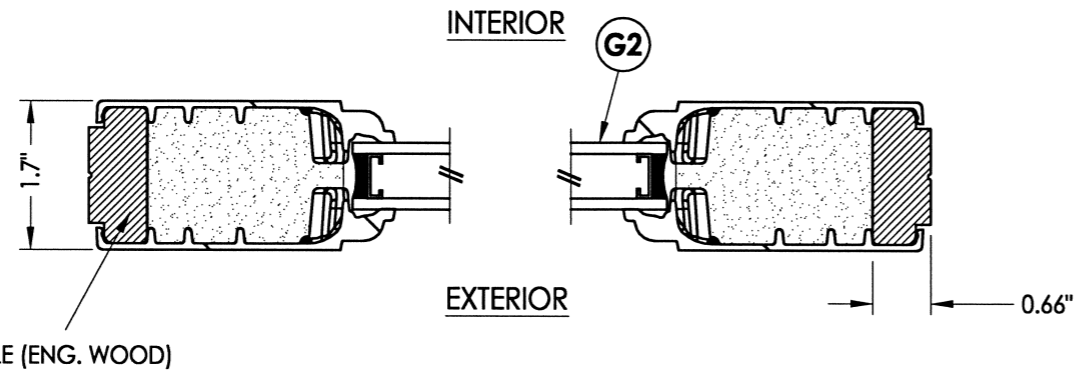

1 HORIZONTAL CROSS SECTION

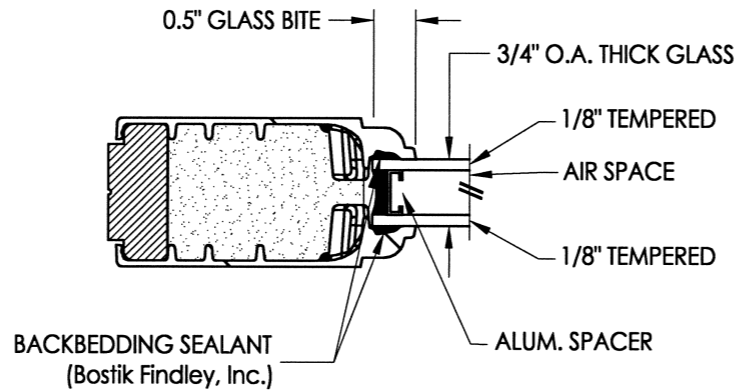

G2 GLAZING DETAIL
Flush Glazed

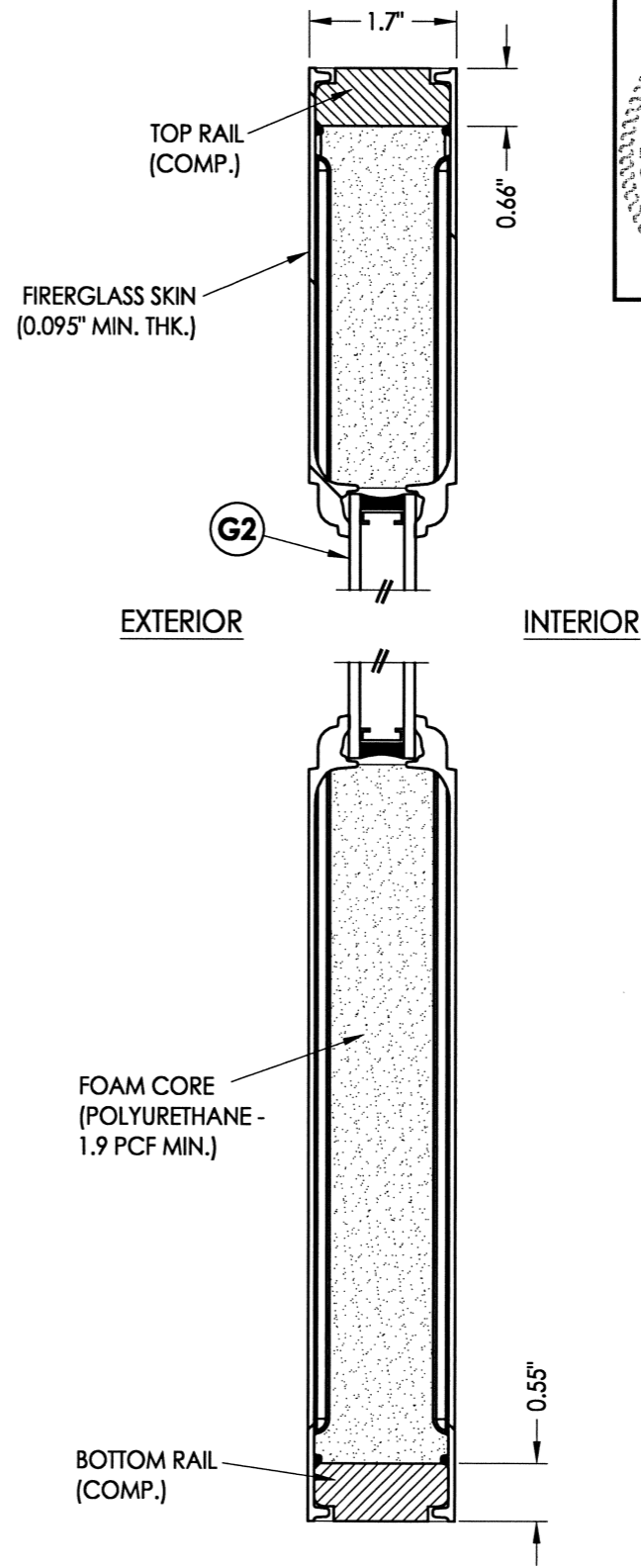

2 VERTICAL CROSS SECTION

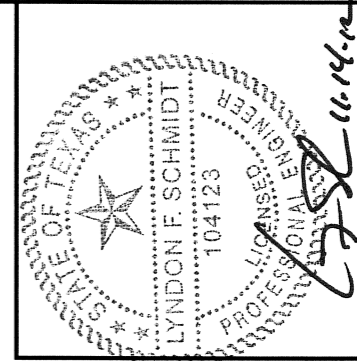

Documents Prepared By: Lyndon F. Schmidt, P.E.
TEXAS P.E. #104123

RW BUILDING CONSULTANTS, INC.
P.O. Box 230 Valrico FL 33595
Phone No.: 813.659.9197

TEXAS BOARD OF PROFESSIONAL ENGINEERS
CERTIFICATE OF REGISTRATION # F-11852

PRODUCT:	THERMA-TRU FIBERGLASS DOOR
PART OR ASSEMBLY:	SIDELITE PANEL & GLAZING DETAIL (CLASSIC CRAFT)

NO.	DATE	BY	REVISIONS

DATE: 10/08/12

SCALE: N.T.S.

DWG. BY: JK

CHK. BY: LFS

DRAWING NO.:

TX-4265

SHEET 6 OF 13

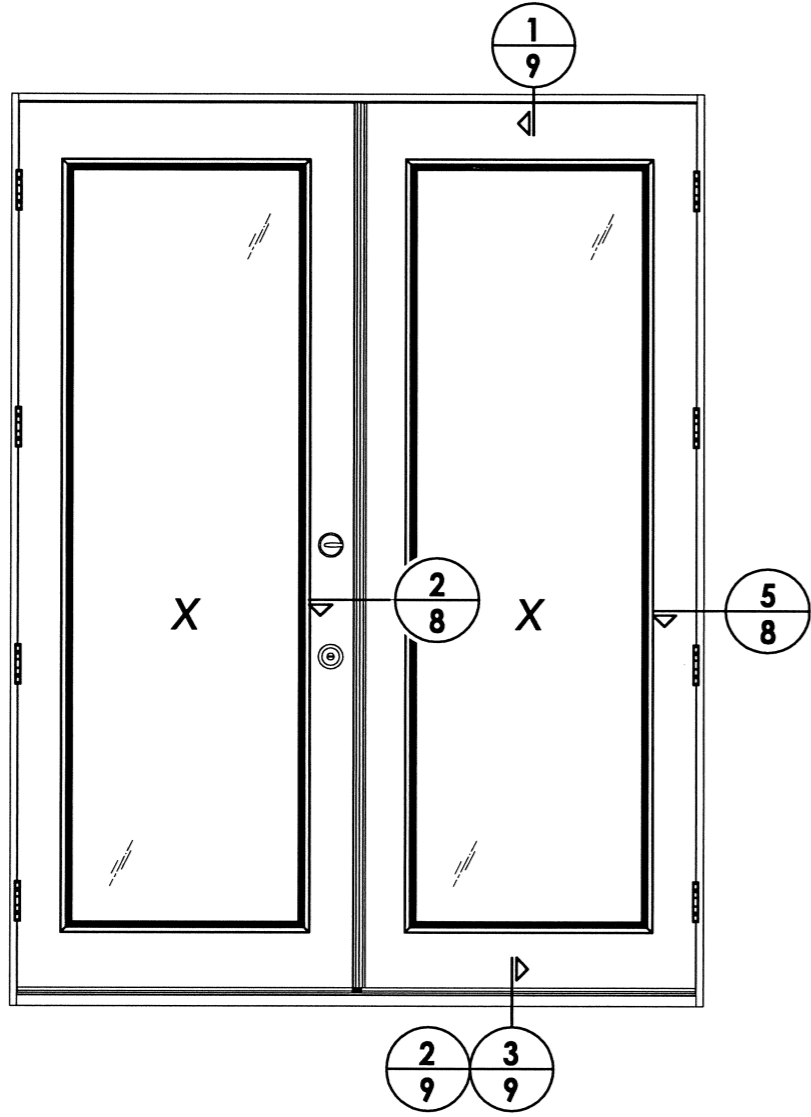

ELEVATION (XX)

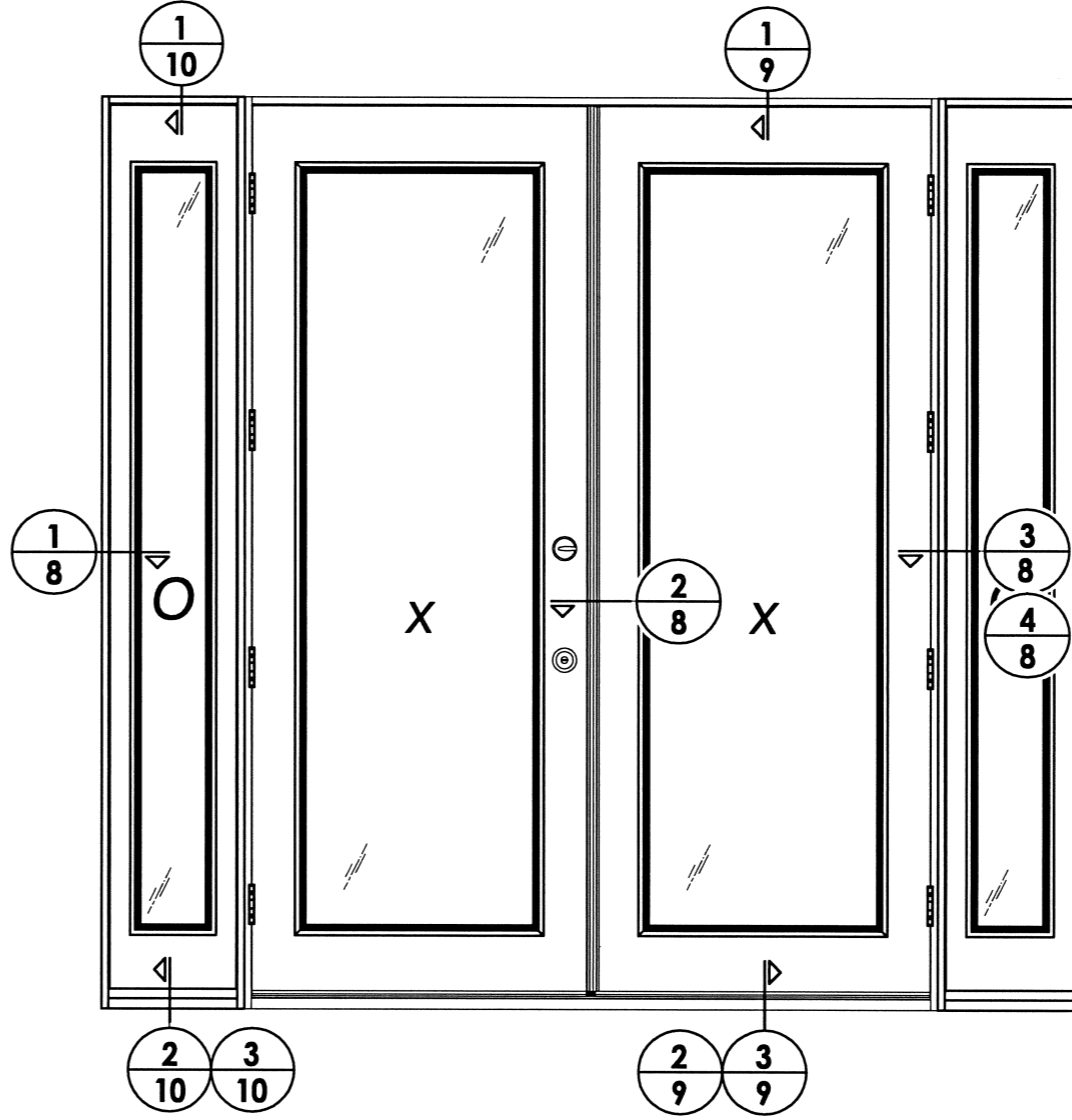

ELEVATION (OXXO)

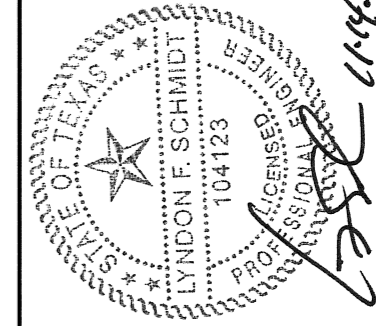

Documents Prepared By: Lyndon F. Schmidt, P.E.
TEXAS P.E. #104123

RW BUILDING CONSULTANTS, INC.
P.O. Box 230 Valrico FL 33595
Phone No.: 813.659.9197

TEXAS BOARD OF PROFESSIONAL ENGINEERS
CERTIFICATE OF REGISTRATION # F-11852

PRODUCT: THERMA-TRU
FIBERGLASS DOOR

PART OR ASSEMBLY:
ELEVATIONS

NO.	DATE	REVISIONS	BY

DATE: 10/08/12

SCALE: N.T.S.

DWG. BY: JK

CHK. BY: LFS

DRAWING NO.:
TX-4265

SHEET 7 OF 13

R:\A - Projects\Project Folders\Proj_1601 - 1700\PE_1694\DWG_RWBC Drawings\Texas 2012\TX-4264-65.dwg - 8.2

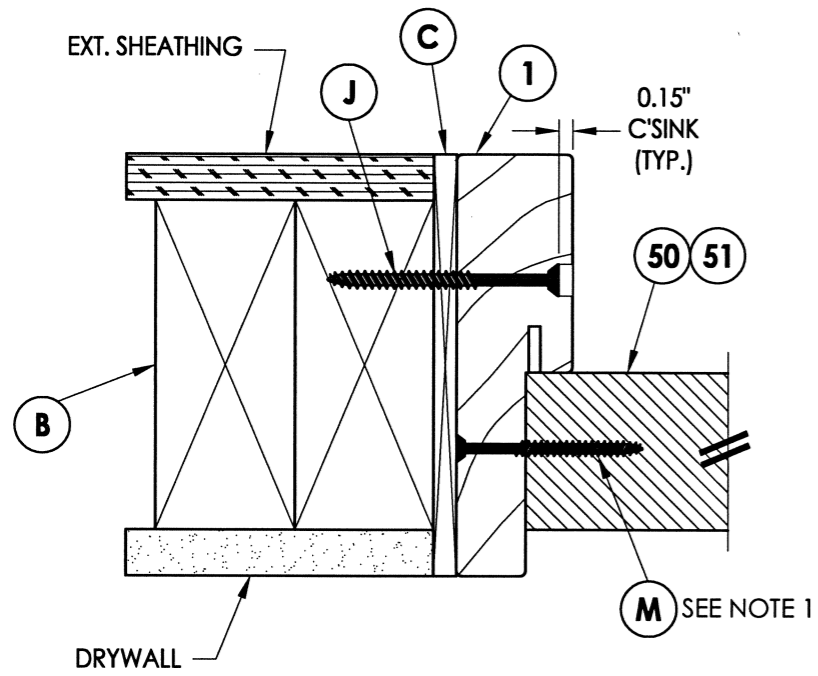

1 HORIZONTAL CROSS SECTION
8 Inswing shown - Outswing also approved

EXTERIOR

INTERIOR

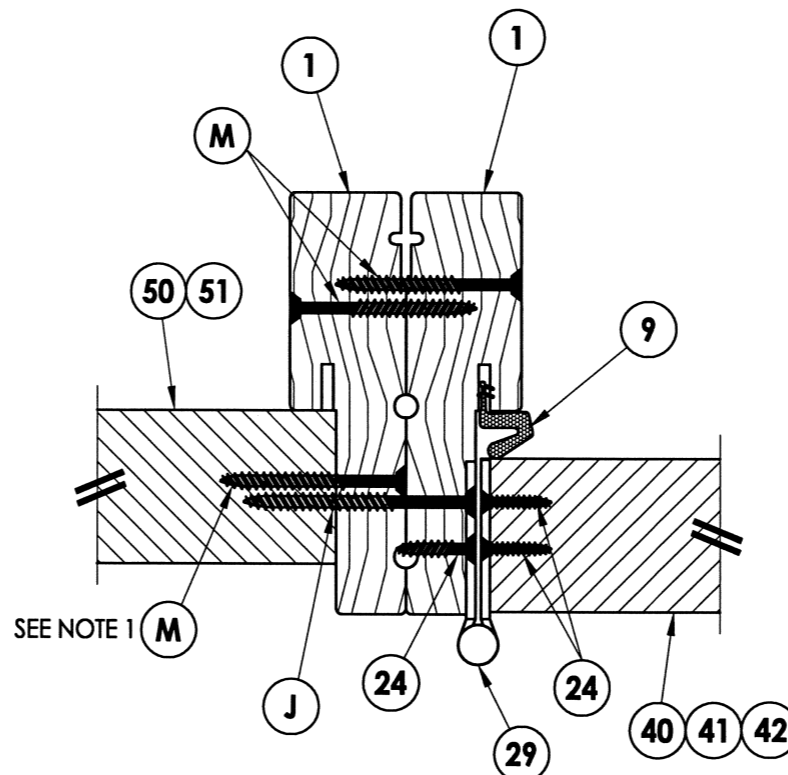

3 HORIZONTAL CROSS SECTION
8 Inswing shown

SEE NOTE 1 M

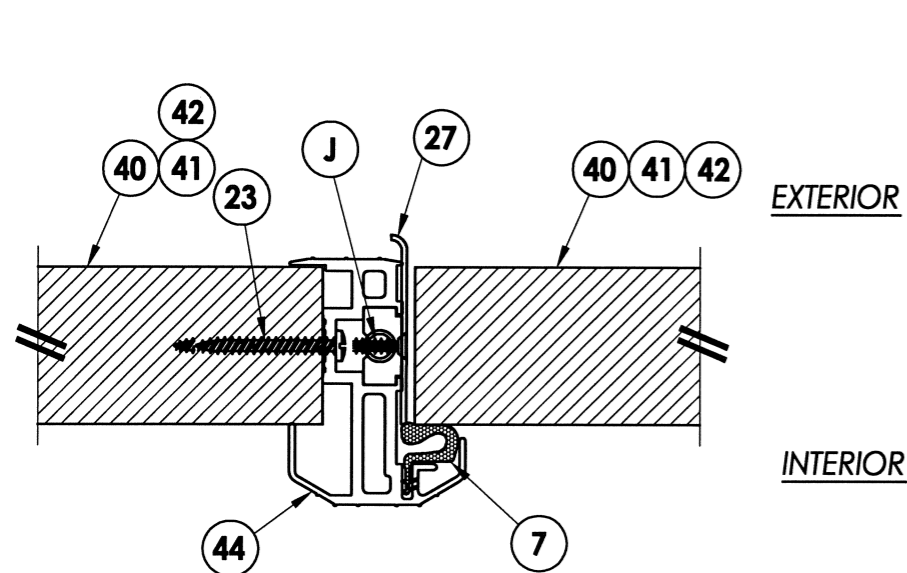

2 HORIZONTAL CROSS SECTION
8 Outswing shown - Inswing also approved

EXTERIOR

INTERIOR

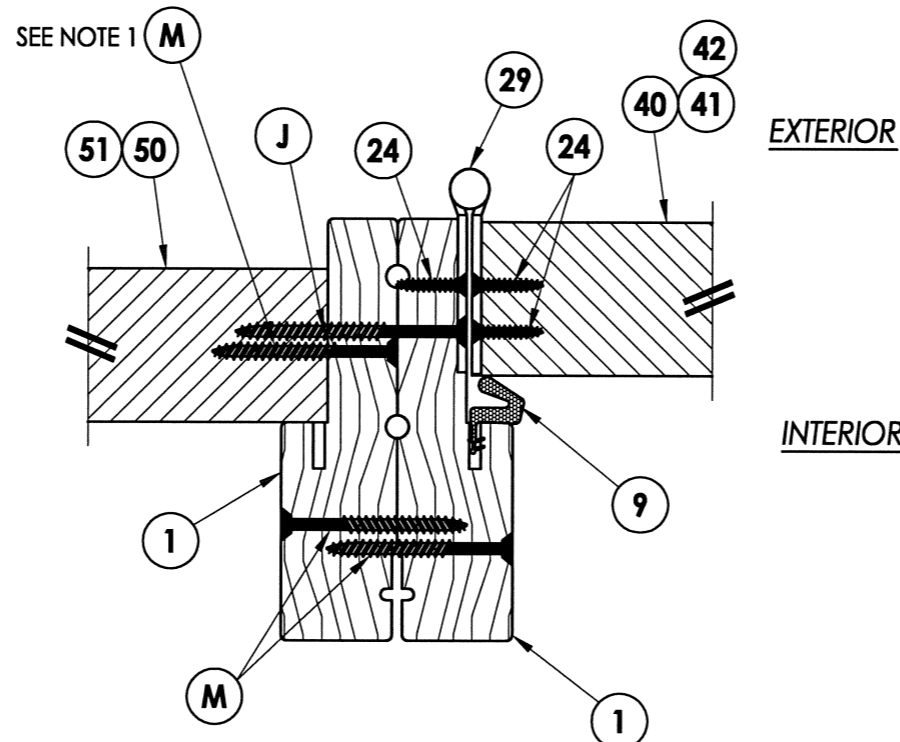

4 HORIZONTAL CROSS SECTION
8 Outswing shown

EXTERIOR

INTERIOR

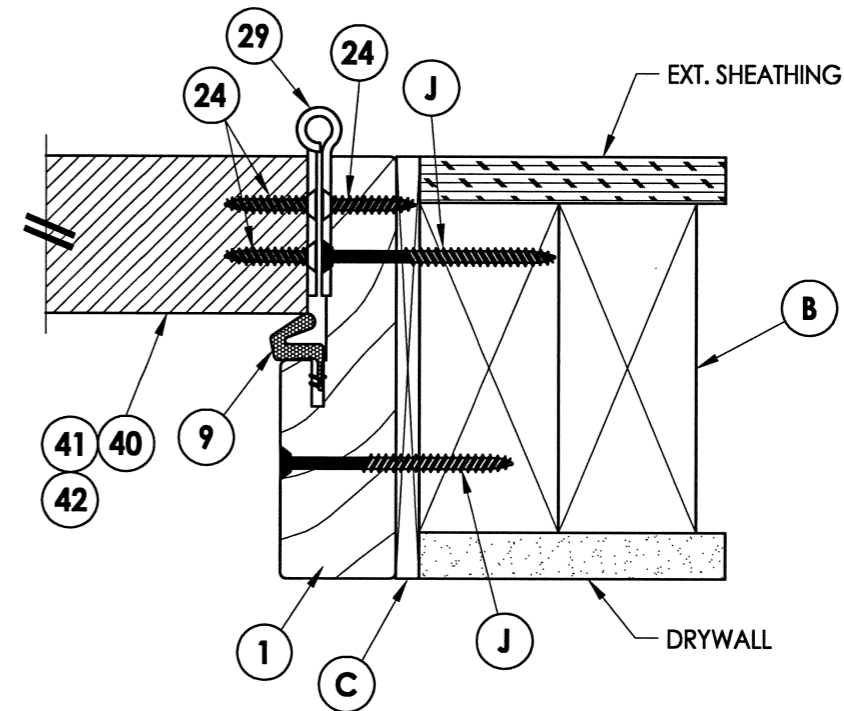

5 HORIZONTAL CROSS SECTION
8 Outswing shown - Inswing also approved

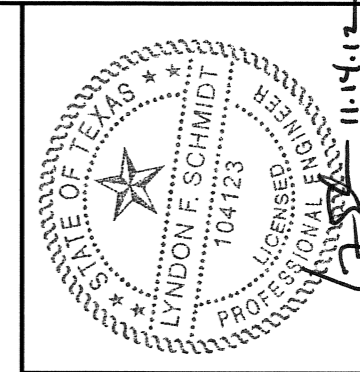

Note:
 1. Sidelite assembly screws located 6" from each end plus 4 more equally spaced (6 total).

Documents Prepared By: Lyndon F. Schmidt, P.E.
 TEXAS P.E. #104123
RW BUILDING CONSULTANTS, INC.
 P.O. Box 230 Valrico FL 33595
 Phone No.: 813.659.9197
 TEXAS BOARD OF PROFESSIONAL ENGINEERS
 CERTIFICATE OF REGISTRATION # F-11852

PRODUCT: THERMA-TRU
 FIBERGLASS DOOR
 PART OR ASSEMBLY:
 HORIZONTAL CROSS SECTIONS

NO.	DATE	BY	REVISIONS

DATE: 10/08/12
 SCALE: N.T.S.
 DWG. BY: JK
 CHK. BY: LFS
 DRAWING NO.: TX-4265
 SHEET 8 OF 13

© 2012 R.W. BUILDING CONSULTANTS INC.

R:\A - Projects\Project Folders\Proj_1601 - 1700\PF_1694\D. RWBC Drawings\Texas 2012\TX-4264-65.dwg, 9.2

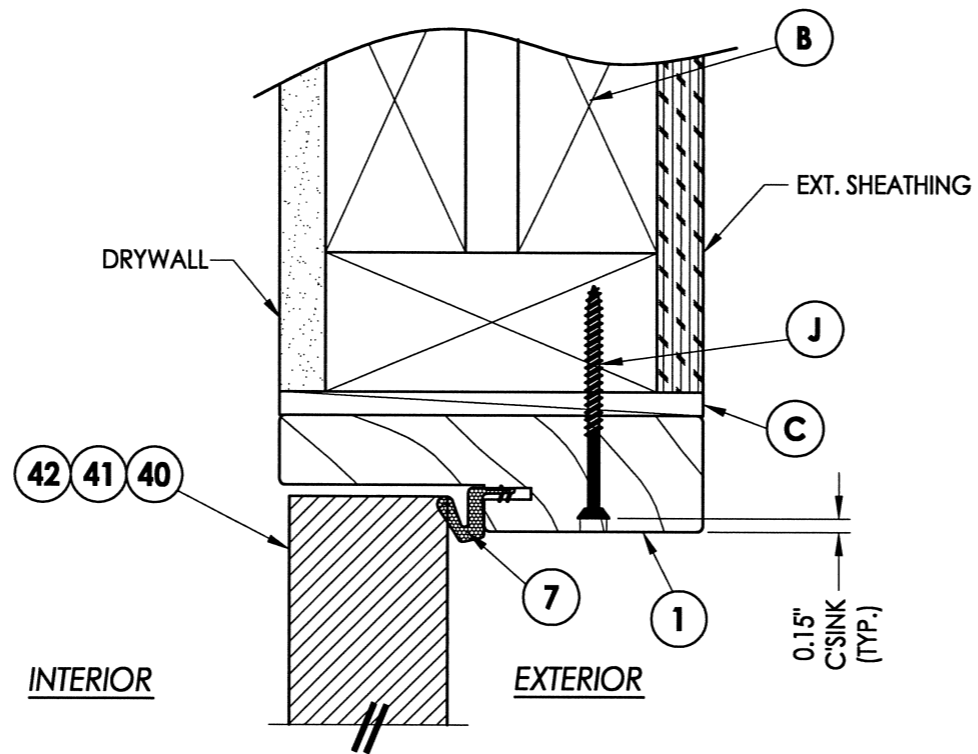

1 VERTICAL CROSS SECTION
9 Inswing shown - Outswing also approved

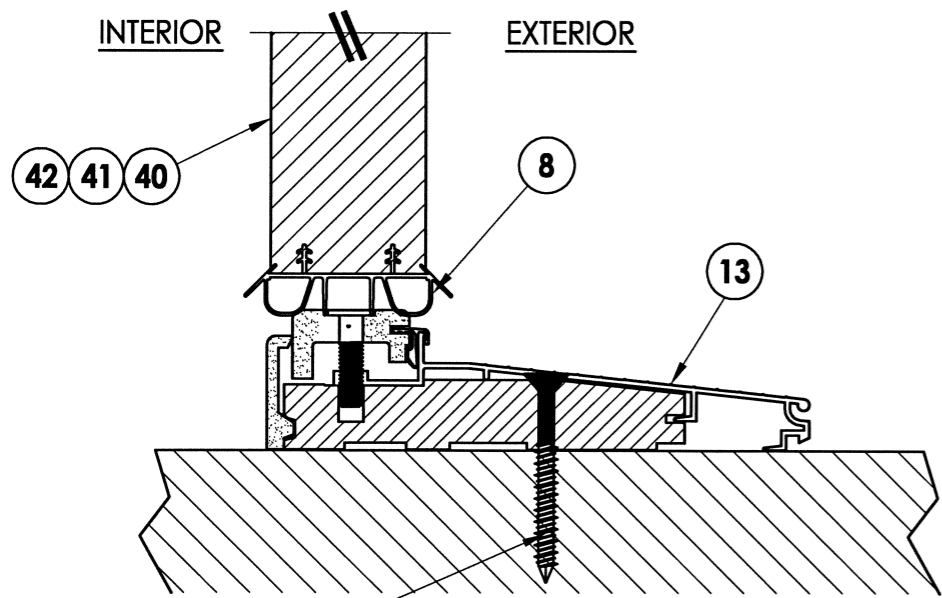

J WOOD
P CONCRETE
2 VERTICAL CROSS SECTION
9 Inswing configuration

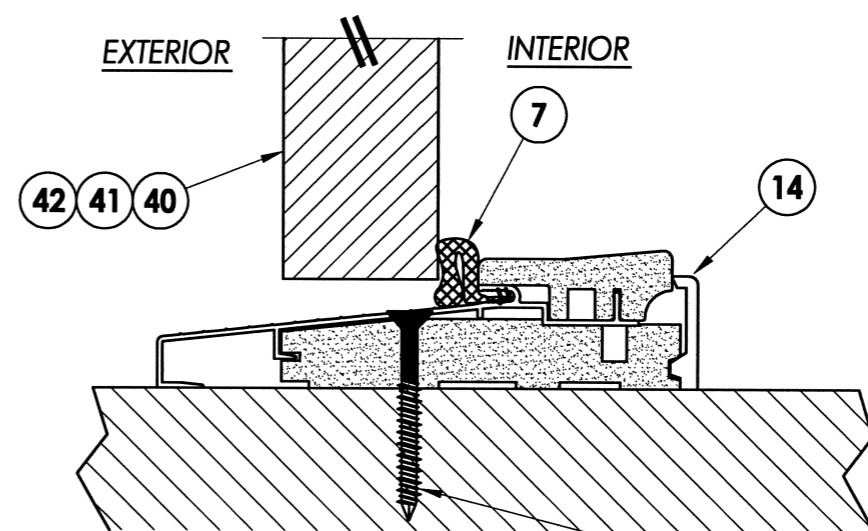

J WOOD
P CONCRETE
3 VERTICAL CROSS SECTION
9 Outswing configuration

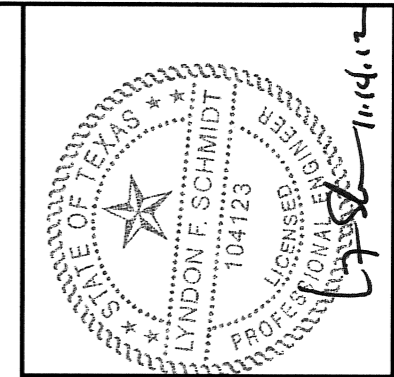

Documents Prepared By: Lyndon F. Schmidt, P.E.
 TEXAS P.E. #104123

RW BUILDING CONSULTANTS, INC.
 P.O. Box 230 Valrico FL 33595
 Phone No.: 813.659.9197

TEXAS BOARD OF PROFESSIONAL ENGINEERS
 CERTIFICATE OF REGISTRATION # F-11852

PRODUCT: THERMA-TRU
 FIBERGLASS DOOR
 PART OR ASSEMBLY: VERTICAL CROSS SECTIONS

NO.	DATE	BY	REVISIONS

DATE: 10/08/12
 SCALE: N.T.S.
 DWG. BY: JK
 CHK. BY: LFS
 DRAWING NO.: TX-4265
 SHEET 9 OF 13

R:\A - Projects\Project Folders\Proj.1601 - 1700\PF_16941D_RWBC Drawings\Texas 2012\TX-4264-65.dwg_10.2

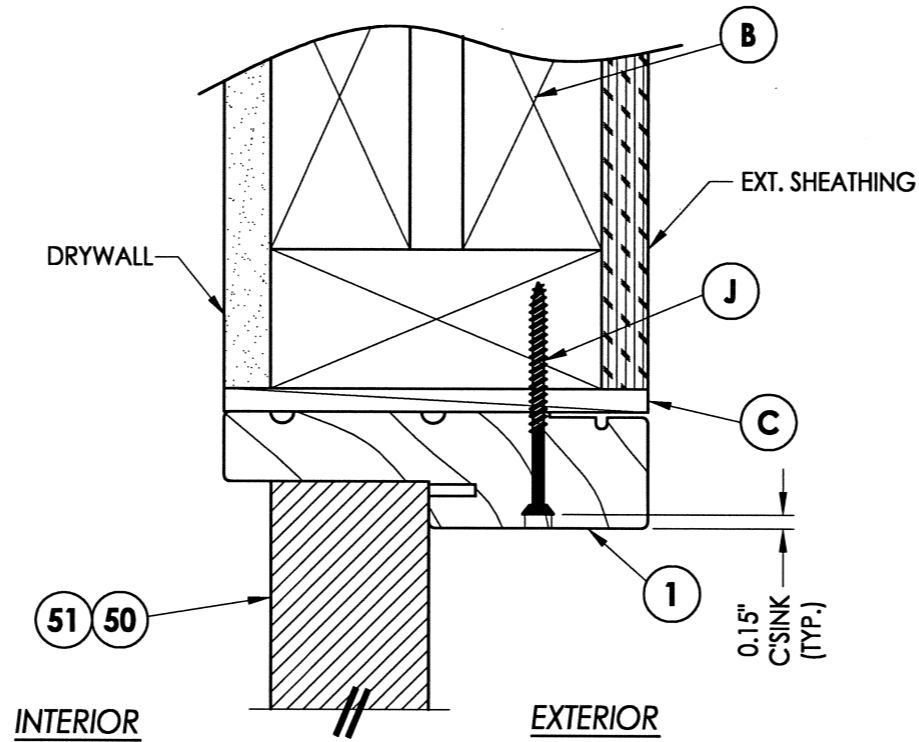

1 VERTICAL CROSS SECTION
10 Inswing shown - Outswing also approved

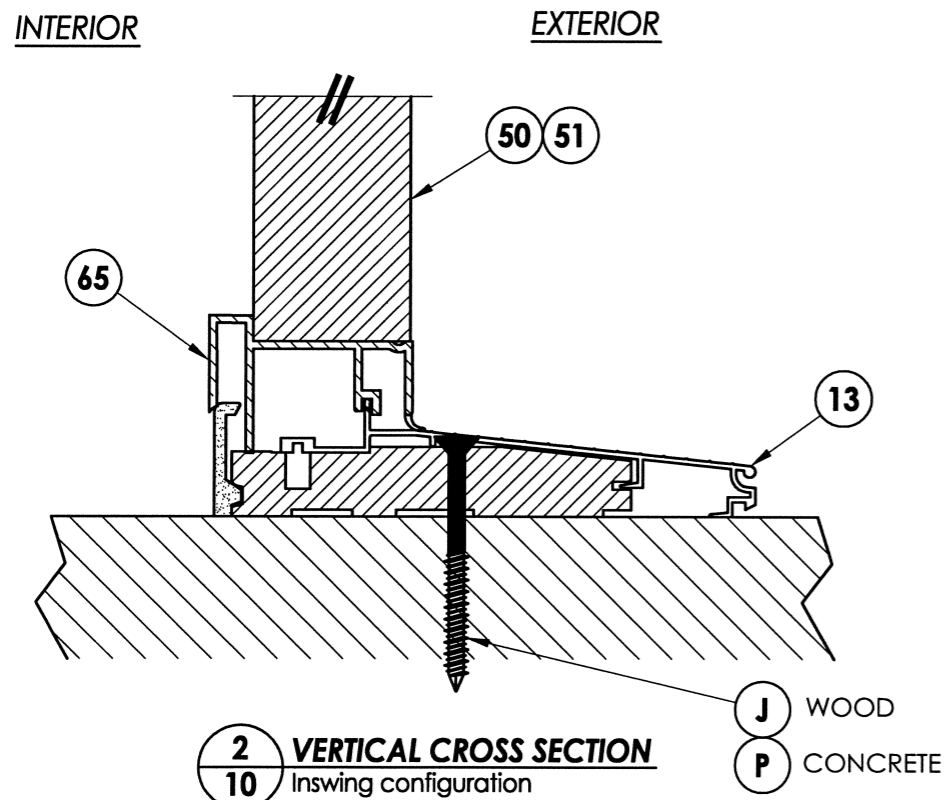

2 VERTICAL CROSS SECTION
10 Inswing configuration

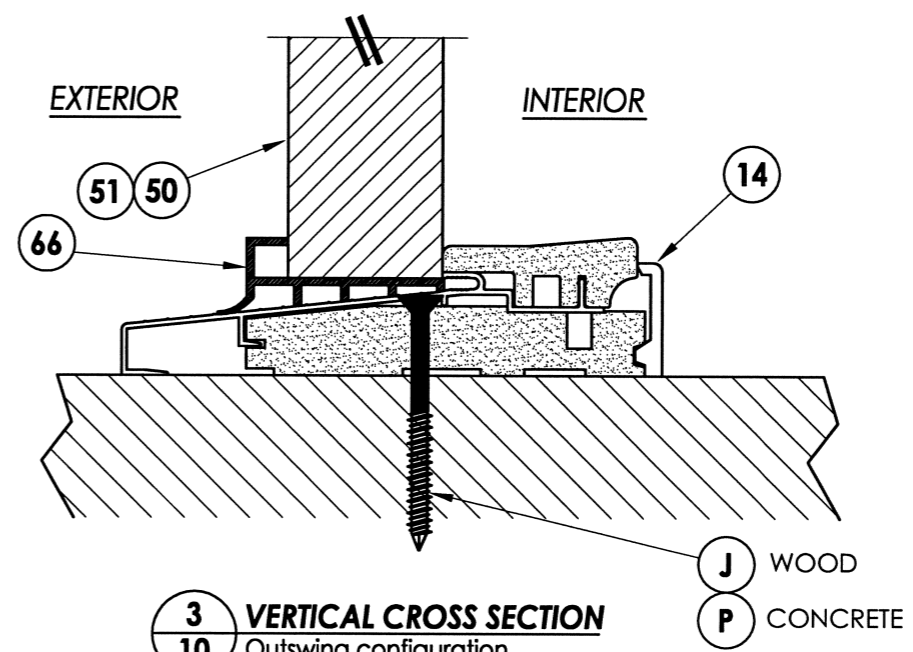

3 VERTICAL CROSS SECTION
10 Outswing configuration

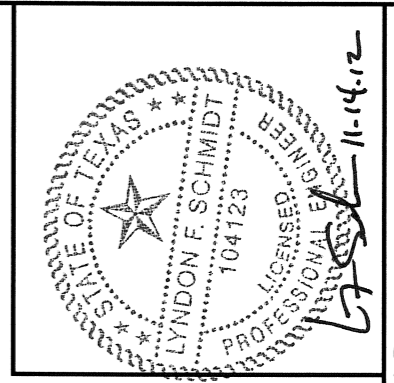

Documents Prepared By: Lyndon F. Schmidt, P.E.
 TEXAS P.E. #104123

RW BUILDING CONSULTANTS, INC.
 P.O. Box 230 Valrico FL 33595
 Phone No.: 813.659.9197
 TEXAS BOARD OF PROFESSIONAL ENGINEERS
 CERTIFICATE OF REGISTRATION # F-11852

PRODUCT: THERMA-TRU FIBERGLASS DOOR		PART OR ASSEMBLY: VERTICAL CROSS SECTIONS	
NO.	DATE	BY	REVISIONS
DATE: 10/08/12		SCALE: N.T.S.	
DWG. BY: JK		CHK. BY: LFS	
DRAWING NO.: TX-4265		SHEET 10 of 13	

R:\A - Projects\Project Folders\Proj 1601 - 1700\PF 1694\D. RWBC Drawings\Texas 2012\TX-4264-65.dwg, 11.2

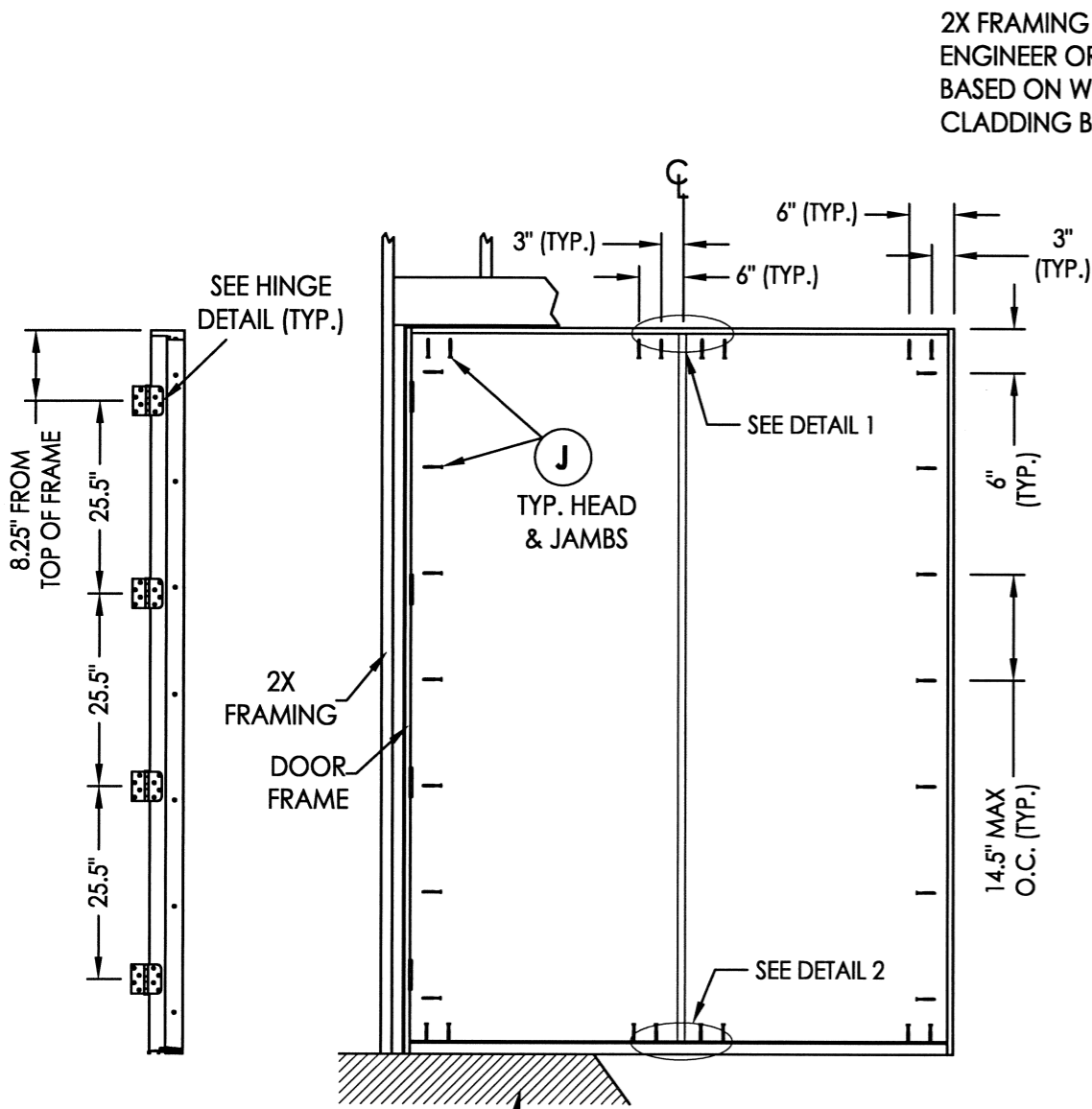

2X FRAMING TO BE DESIGNED BY THE ENGINEER OR ARCHITECT OF RECORD BASED ON WIND LOADS AND THE CLADDING BEING USED (TYP.).

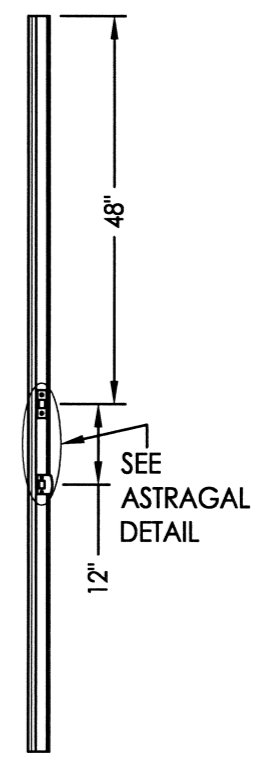
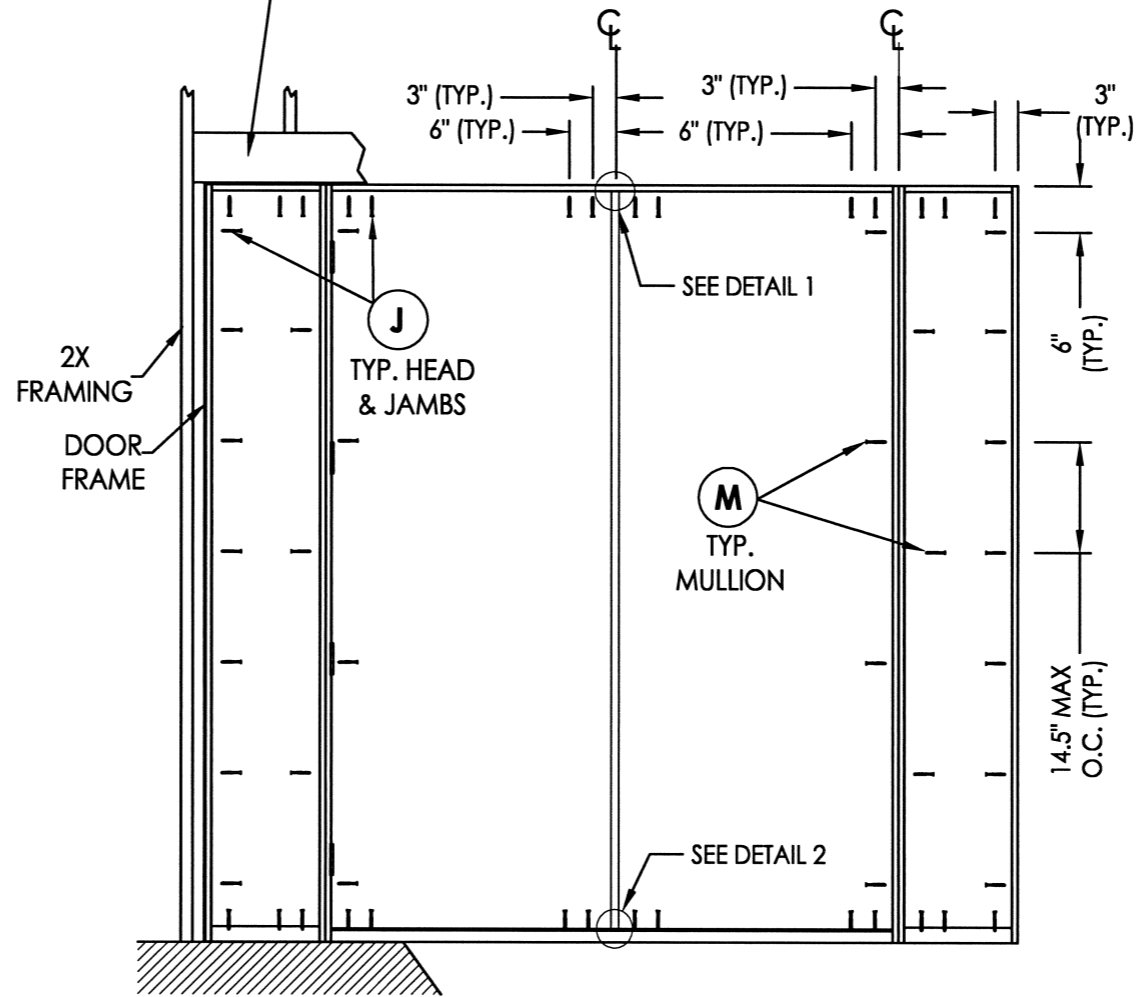

HINGE JAMB

FRAME ANCHORING
XX

FRAME ANCHORING
OXXO

ASTRAGAL STRIKE

FLOOR SUBSTRATE MATERIAL (TYP.)
CONCRETE (MIN. 3000 PSI)
WOOD (S.G. >= 0.42)

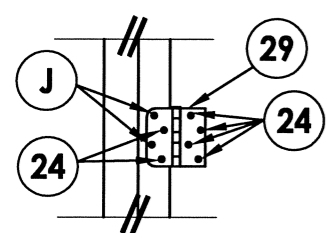

HINGE DETAIL
Inswing

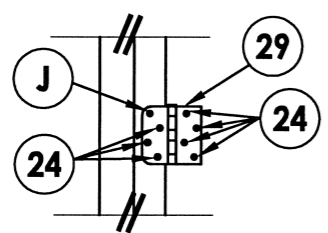

HINGE DETAIL
Outswing

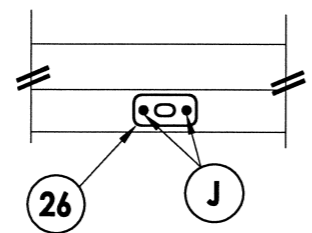

DETAIL 1
Astragal Strike Plate

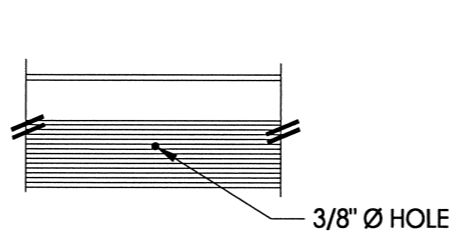

DETAIL 2
Astragal throw bolt hole
Outswing

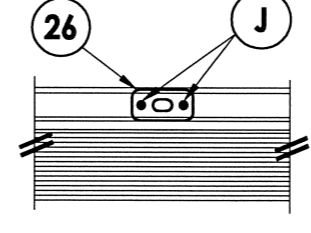

DETAIL 2
Astragal Strike Plate
Inswing

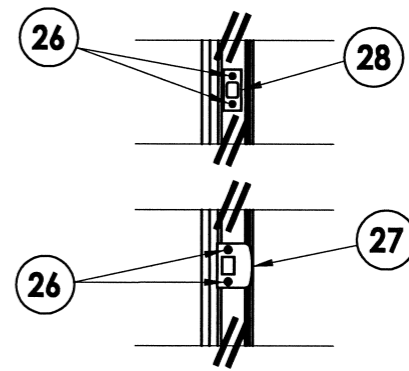

ASTRAGAL DETAIL
@ Strike

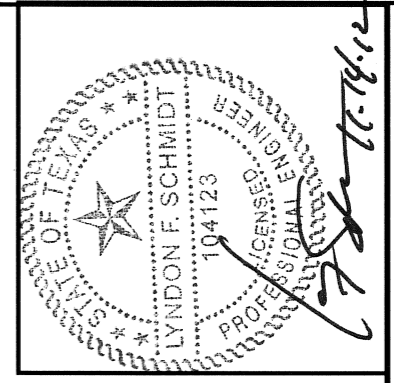

Documents Prepared By: Lyndon F. Schmidt, P.E.
TEXAS P.E. #104123

RW BUILDING CONSULTANTS, INC.
P.O. Box 230 Valrico FL 33595
Phone No.: 813.659.9197
TEXAS BOARD OF PROFESSIONAL ENGINEERS
CERTIFICATE OF REGISTRATION # F-11852

PRODUCT: THERMA-TRU
FIBERGLASS DOOR
PART OR ASSEMBLY: FRAME ANCHORING

NO.	DATE	BY	REVISIONS

DATE: 10/08/12
SCALE: N.T.S.
DWG. BY: JK
CHK. BY: LFS
DRAWING NO.: TX-4265
SHEET 11 OF 13

© 2012 R.W. BUILDING CONSULTANTS INC.

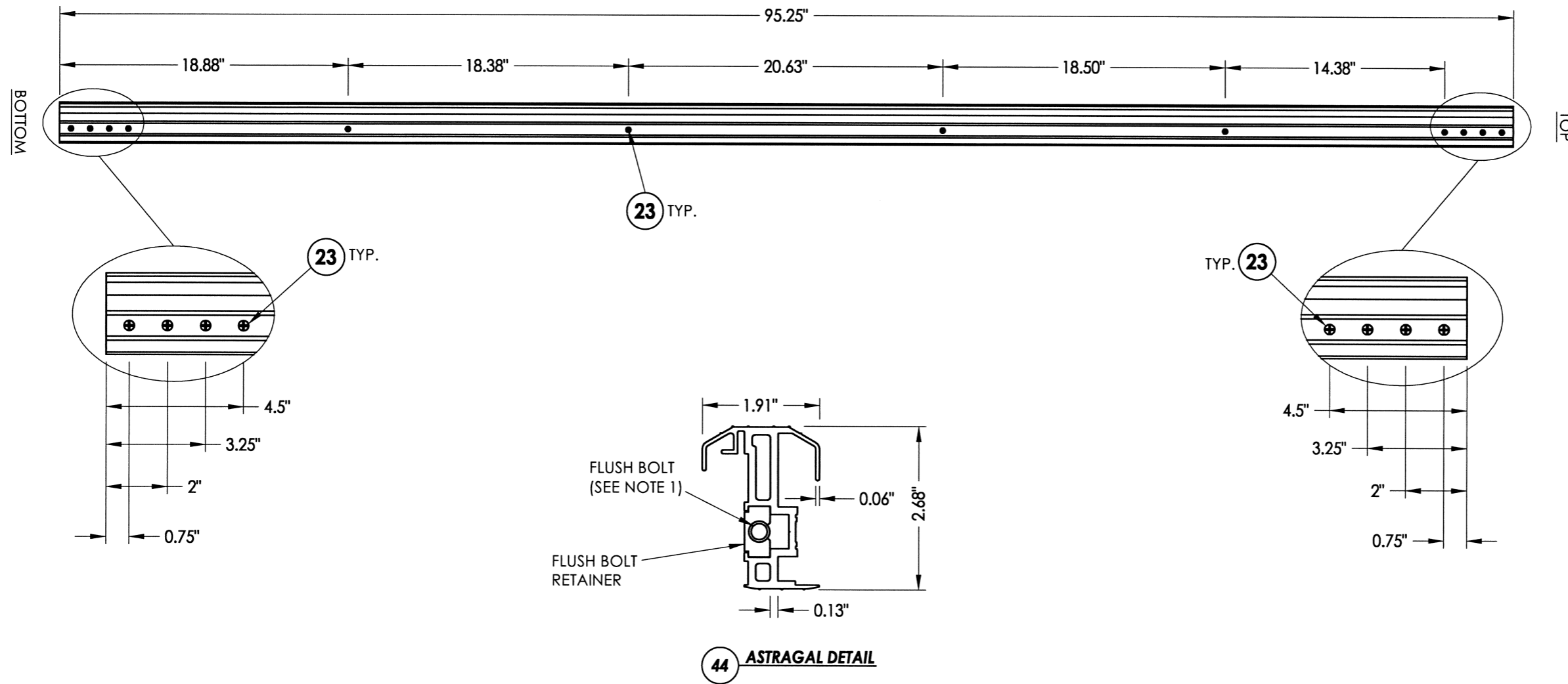

NOTE:

1. THE ASTRAGAL BOLT HAS A 3" THROW AT THE TOP AND AT THE BOTTOM.

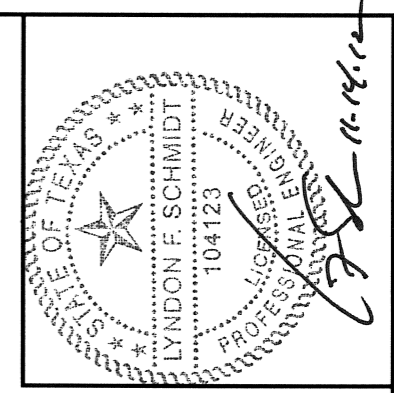

Documents Prepared By: Lyndon F. Schmidt, P.E.
TEXAS P.E. #104123

RW BUILDING CONSULTANTS, INC.
P.O. Box 230 Valrico FL, 33595
Phone No.: 813.659.9197

TEXAS BOARD OF PROFESSIONAL ENGINEERS
CERTIFICATE OF REGISTRATION # F-11852

PRODUCT: THERMA-TRU
FIBERGLASS DOOR
PART OR ASSEMBLY: ASTRAGAL DETAILS

NO.	DATE	BY	REVISIONS

DATE: 10/08/12
SCALE: N.T.S.
DWG. BY: JK
CHK. BY: LFS
DRAWING NO.: TX-4265
SHEET 12 OF 13

R:\A - Projects\Project Folders\Proj 1601 - 1700\PF 1694\DWBC Drawings\Texas 2012\TX-4264-65.dwg, 13.2

BILL OF MATERIALS

ITEM #	DESCRIPTION	MATERIAL
B	2X BUCK (SG >= 0.42)	WOOD
C	1/4" MAX. SHIM SPACE	-
J	#10 X 2-1/2" PFH WOOD SCREW (MIN. EMB. = 1.15" HEAD/JAMBS, 1-1/2" SILL)	STEEL
M	#10 X 2" PFH WOOD SCREW	STEEL
P	1/4" PFH ELCO OR ITW CONCRETE SCREW (1-3/4" MIN. EMB.)	STEEL
1	JAMB - FINGER JOINTED PINE	WOOD
7	WEATHERSTRIP (Long Reach by Therma-Tru)	FOAM
8	SWEEP	VINYL
9	WEATHERSTRIP (Medium Reach by Therma-Tru)	FOAM
13	INSWING THRESHOLD	ALUM/COMP
14	OUTSWING THRESHOLD	ALUM/COMP
23	#10 X 1-1/2" PH SMS	STEEL
24	#10 x 1" PFH WOOD SCREW	STEEL
26	ASTRAGAL STRIKE PLATE	STEEL
27	LATCH STRIKE PLATE	STEEL
28	DEADBOLT STRIKE PLATE	STEEL
29	4" X 4" HINGE	STEEL
40	DOOR PANEL (SMOOTH STAR/FIBER CLASSIC)	-
41	DOOR PANEL (SMOOTH STAR/FIBER CLASSIC)	-
42	DOOR PANEL (CLASSIC CRAFT)	-
44	HURRICANE ASTRAGAL	-
50	SIDELITE PANEL (SMOOTH STAR/FIBER CLASSIC)	-
51	SIDELITE PANEL (CLASSIC CRAFT)	-
65	INSWING SIDELITE ADAPTER	PVC
66	OUTSWING SIDELITE ADAPTER	PVC

CONCRETE ANCHOR NOTES:

- Concrete anchor locations at the corners may be adjusted to maintain the min. edge distance to mortar joints.
- Concrete anchor locations noted as "MAX. ON CENTER" must be adjusted to maintain the min. edge distance to mortar joints, additional concrete anchors may be required to ensure the "MAX. ON CENTER" dimension are not exceeded.
- Concrete anchor table:

ANCHOR TYPE	ANCHOR SIZE	MIN. EMBEDMENT	MIN. CLEARANCE TO MASONRY EDGE	MIN. CLEARANCE TO ADJACENT ANCHOR
ITW TAPCON®	1/4"	1-3/4"	2-1/2"	3"
ELCO ULTRACON®	1/4"	1-3/4"	1"	3"

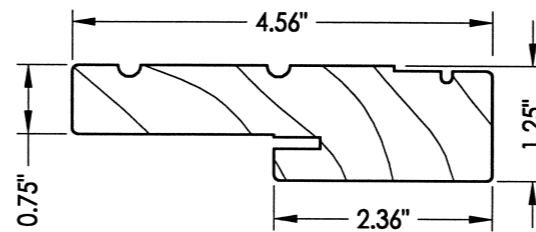

1 WOOD JAMB

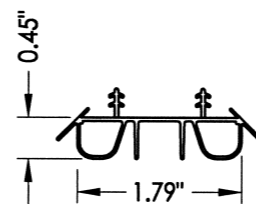

8 SWEEP

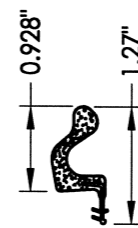

7 WEATHERSTRIP Long Reach

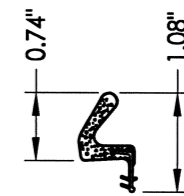

9 WEATHERSTRIP Medium Reach

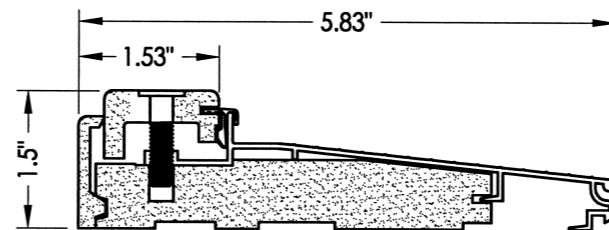

13 INSWING THRESHOLD

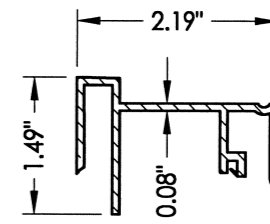

65 INSWING SIDELITE ADAPTER

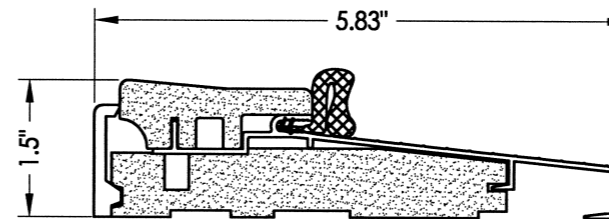

14 OUTSWING THRESHOLD

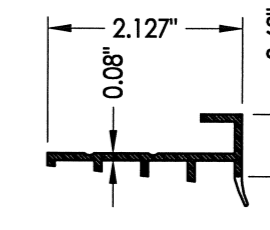

66 OUTSWING SIDELITE ADAPTER



Documents Prepared By: Lyndon F. Schmidt, P.E.
TEXAS P.E. #104123

RW BUILDING CONSULTANTS, INC.
P.O. Box 230 Valrico FL 33595
Phone No.: 813.659.9197

TEXAS BOARD OF PROFESSIONAL ENGINEERS
CERTIFICATE OF REGISTRATION # F-11852

PRODUCT: THERMA-TRU FIBERGLASS DOOR

PART OR ASSEMBLY: BILL OF MATERIALS & COMPONENTS

NO.	DATE	BY	REVISIONS

DATE: 10/08/12
SCALE: N.T.S.
DWG. BY: JK
CHK. BY: LFS
DRAWING NO.: TX-4265
SHEET 13 OF 13